

VANITY

Let's face it – the bathroom is usually one of the hardest areas to keep tidy with all those odds and ends...at least, it used to be. Now, organizing your bathroom with Rev-A-Shelf® is easy with all the storage solutions in our vanity and bathroom accessory line. Hide your unsightly garbage with a pullout waste container, keep dirty clothes off the floor with a removable pullout hamper, expand your bathroom drawer, neatly arrange makeup and more with a cosmetic organizer and power-up your vanity with an electrical drawer or pullout. The choices are limitless. In this section, you'll find everything you need to keep your bathroom organized.

Innovation through Organization™

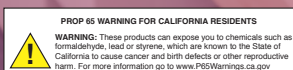

4WHOX Series

Bottom Mount Hamper w/ OXO Container



- Designed for 24" base cabinets
- Natural maple dovetail construction with a semi-gloss finish
- BLUM soft-close slides
- Patented door-mount brackets with micro-adjustment (US Patent No. 8,338,076)
- (1) reversible left-hand or right-hand mounted compartment
- (2) Configurations
 - (1) 1.5 BU hamper
 - (1) 1.7 BU hamper, (1) 1.7 qt. OXO container and maple beauty ring
- Mounts to cabinet floor and door
- TSCA Title VI compliant

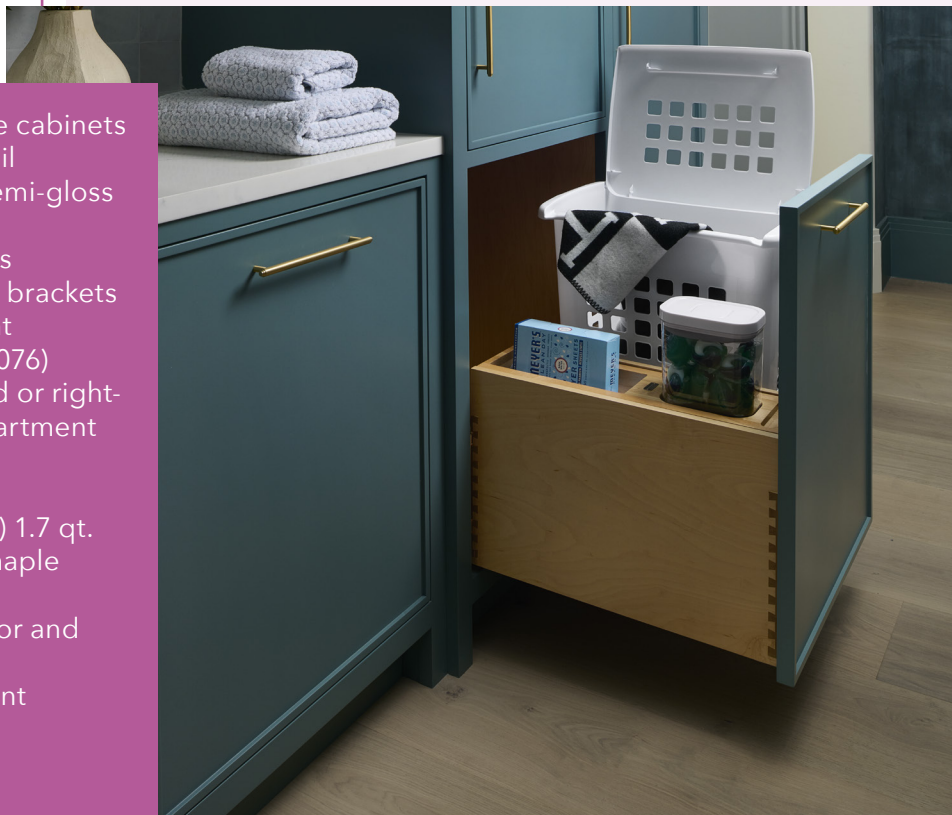

4WHOX-24DMSC-1



4WHOX-24FHDMS-1
1.7 Bushel Hamper Pullout
w/ OXO and Storage



Reversible compartment for
additional storage

Wood Bottom-Mount Hamper System w/ OXO & Storage

PRODUCT	DESCRIPTION	DIMS	MCO	CAB	FINISH	SLP
4WHOX-24FHDMS-1	1.7 BU Hamper w/ Storage	21" (534 mm) W x 22" (559 mm) D x 24-1/2" (623 mm) H	21" (534 mm)	FHB24	Maple	\$639.90
4WHOX-24DMSC-1	1.5 BU Hamper w/ Storage	21" (534 mm) W x 22" (559 mm) D x 19-15/16" (507 mm) H	21" (534 mm)	B24	Maple	\$634.10

Maple U-Shaped Vanity Pullout

486 Series



- Designed for 30" vanity sink base cabinets
- Natural maple construction with semi-gloss finish
- Full-extension, undermount slides w/ BLUM soft-close
- Mounts to cabinet floor or side walls
- Side and bottom mount brackets
- (4) adjustable dividers, (1) 8 L waste container w/ white lid (BM), or (4) adjustable dividers and (2) removable polycarbonate bins (SM)
- Non-skid vinyl lining
- TSCA Title VI compliant

486-30VSBSC-BM-1



Can be door mounted

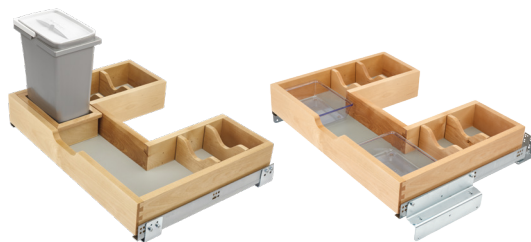

486-30VSBSC-BM-1

Maple U-Shaped Pullout
w/ (4) Adjustable Dividers and
(1) 8 L Container
(Bottom mount unit shown)

486-30VSBSC-SM-1

Maple U-Shaped Pullout
w/ (4) Adjustable Dividers and
(2) Acrylic Bins
(Side mount unit shown)

See page 105 for sink base version



Scan for video

U-Shaped Vanity Pullout w/ BLUM Soft-Close

PRODUCT	DESCRIPTION	DIMS	MCO	CAB	FINISH	SLP
486-30VSBSC-BM-1	Bottom Mount	25-21/32" (652 mm) W x 18-11/16" (475 mm) D x 14-1/4" (362 mm) H	25" (635 mm) - FF 25-3/4" (654 mm) - FL	VSB30	Maple	\$407.45
486-30VSBSC-SM-1	Side Mount	27-9/16" - 28-3/4" (700 - 731 mm) W x 19" - 20-3/4" (483 - 528 mm) D x 6-1/2" (166 mm) H	25" (635 mm) - FF	VSB30	Maple	\$384.25



- Designed for 12" full-height vanity cabinets with 1-3/4", 1-1/2" and 1-5/8" face frames
- Natural maple construction with semi-gloss finish
- (2) shelves with acrylic accents
- Full-extension, undermount slides w/ BLUM soft-close
- Patented foldable slide set for easy installation (US Patent No. 10,799,020)
- Mounts to cabinet door, floor and side
- Patented door-mount brackets provide 5" of adjustability and include micro-trim adjuster (US Patent No. 8,388,076)
- Non-skid vinyl lining
- (2) removable stainless-steel bins
- In-drawer receptacle with (2) 120V plugs
- Tamper-resistant outlets
- Max Current: AC 12 amps @ 120VAC
- UL Recognized to UL962/ CSA-C22.2 no. 0-10
- Power cord with NEMA 5 - 15 plug
- Integrated cord guide ensures safe operation
- Drawer stop prevents items from being stored "ON" inside the cabinet
- Its end use determines the overall safety of this product
- US Patent No. 20210022492A1
- TSCA Title VI compliant



445-VBOSC-8C



445-VBOSC-8C

Outlet Grooming Organizer



Scan for video



Face Frame Vanity Outlet Grooming Organizer Pullout w/ BLUM Soft-Close

PRODUCT	DESCRIPTION	DIMS	MCO	CAB	FINISH	SLP
445-VBOSC-8C	Grooming Organizer	9-9/32" (236 mm) W x 20 1/8" (511 mm) D x 26-1/8" (664 mm) H	8-1/2" (216 mm) - FF 9-1/2" (241 mm) - FL	FHVB12	Maple	\$885.25

Vanity Outlet Drawer

4VOD Series



4VOD-18SC-1



- Designed for 18" base cabinet drawers
- Natural maple construction with semi-gloss finish
- (2) compartments
- (2) stainless steel bins
- Full-extension, undermount slides w/ BLUM soft-close
- In-drawer receptacle with (2) 120V plugs
- Tamper resistant outlets
- Max Current: AC 12 amps @ 120VAC
- UL Recognized to UL962/ CSA-C22.2 No. 0-10
- Power cord with NEMA 5 - 15 plug
- Integrated cord guide ensures safe operation
- Patented design prevents items from being accidentally left plugged in when unit is closed (US Patent No. 11,070,038)
- Door-mounting brackets
- Anti-skid lining
- Drawer front not included
- The overall safety of this product is determined by its end use
- TSCA Title VI compliant



4VOD-18SC-1 & 4VOD-18FLSC-1
Vanity Outlet Drawer



Scan for video



Full Access Vanity Outlet Drawer w/ BLUM Soft-Close

PRODUCT	DESCRIPTION	DIMS	MCO	CAB	FINISH	SLP
4VOD-18FLSC-1	Vanity Outlet Drawer	16-1/2" (420 mm) W x 20-1/8" (511 mm) D x 8-15/16" (227 mm) H	16-1/2" (419 mm)	FLVB18	Maple	\$651.05

Face Frame Vanity Outlet Drawer w/ BLUM Soft-Close

4VOD-18SC-1	Vanity Outlet Drawer	15" (381 mm) W x 20-1/2" (521 mm) D x 8-15/16" (227 mm) H	15" (381 mm)	VB18	Maple	\$651.05
-------------	----------------------	---	--------------	------	-------	----------

4VCOS Series

Vanity Drawer Organizer Insert

- Designed for 22" or smaller vanity cabinet drawers
- Natural maple construction with semi-gloss finish
- Trim-to-fit existing drawer
- Drop-in installation
- Anti-skid vinyl lining
- Up to (13) compartments
- (2) clear acrylic lids
- TSCA Title VI compliant



4VCOS-22-1

**4VCOS-22-1**

Vanity Drawer Organizer Insert



Scan for video

22" Vanity Drawer Organizer Insert

PRODUCT	DESCRIPTION	DIMS	FINISH	SLP
4VCOS-22-1	Vanity Drawer Organizer	21-3/4" (553 mm) W x 21-1/8" (537 mm) D x 2" (51 mm) H	Maple	\$155.90

Scale Holder

4SH Series



4SH-15-1

- Designed for 15" vanity base cabinets
- Scale clip holds a min. thickness of 0.8" to 2.0" max.
- Natural maple frame with semi-gloss finish
- Torsion spring with non-skid coating
- Patented adjustable door mount brackets provide up to 5" of adjustability (US Patent No. 7,204,569)
- TSCA Title VI compliant



Can be used for a multitude of things such as cutting boards, cookbooks and more.



4SH-15-1
Scale Holder



Scan for video

Scale Holder

PRODUCT	DESCRIPTION	DIMS	MCO	CAB	FINISH	SLP
4SH-15-1	Scale Holder	10-1/2" (267 mm) W x 3-5/8" (93 mm) D x 12-1/2" (318 mm) H	12" (305 mm)	VB15	Chrome/Maple	\$117.45

- Designed for 30" vanity base (butt door) cabinets
- Natural maple frame with semi-gloss finish
- Mounts to cabinet door
- Non-skid lining on lower level shelf
- (2) 1.25 qt. stainless steel bins
- Patented adjustable door mount brackets provide up to 5" of adjustability (US Patent No. 7,204,569)
- TSCA Title VI compliant



4HD-15-1



4HD-15-1

Vanity Appliance Storage Rack



Scan for video

Vanity Appliance Storage Rack

PRODUCT	DESCRIPTION	DIMS	MCO	CAB	FINISH	SLP
4HD-15-1	Storage Rack	10-3/4" (274 mm) W x 6" (153 mm) D x 13-7/8" (353 mm) H	12-3/8" (314 mm)	SB30 Butt	Maple	\$120.35

Pullout Ironing Board

VIB Series



- Designed for 14-1/2" to 21" vanity cabinet drawer openings
- Complete drawer system, just add your drawer front
- Chrome-plated metal frame
- Over-extension, ball-bearing slides
- Mounts to cabinet side and rear wall
- Built-in ironing board

VIB-20CR



Solid surface counter overlays
CANNOT exceed 1-1/4"



VIB-20CR
Vanity Pullout Ironing Board

See closet section (page 294) for more
ironing board solutions

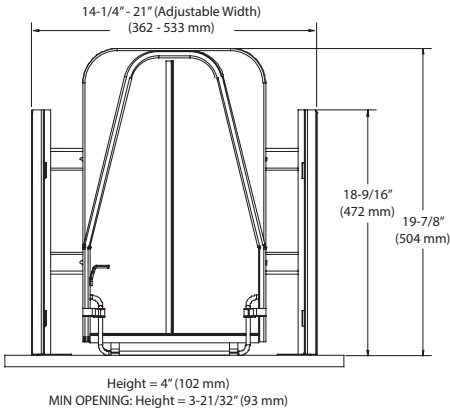

NOTE: Not compatible with inset cabinetry

Vanity Pullout Ironing Board						
PRODUCT	DESCRIPTION	DIMS	MCO	CAB	FINISH	SLP
VIB-20CR	Pullout Ironing Board	See drawings for detailed specifications.	14-1/4" (362 mm)	VB18	Chrome	\$348.00
RAS-VIB-COVER-52	Replacement Cover				Silver	\$26.10

441 Series

L-Shaped Vanity Organizer



- Designed for 24" and 30" vanity sink base cabinets
- Natural maple dovetail construction with semi-gloss finish
- Full-extension, undermount slides w/ BLUM soft-close
- Patented mounting straps (US Patent No. 9,756,941)
- Anti-skid vinyl lining on lower level
- (6) acrylic bins for upper level
- Mounts to cabinet floor
- Patented design (US Patent No. D854,359)
- TSCA Title VI compliant



441-15VSBSC-1



Scan for video



441-12VSBSC-1
Vanity Organizer for 24"

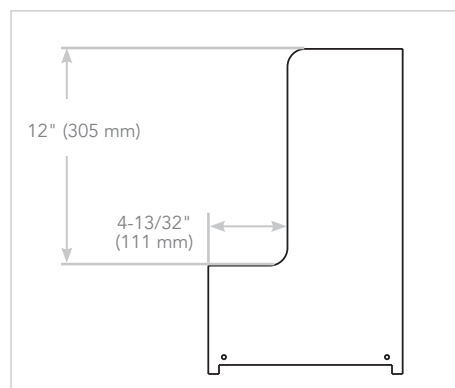

PIPE CLEARANCE DIMENSIONS
(For both units)

L-Shaped Vanity Organizer w/ BLUM Soft-Close

PRODUCT	DESCRIPTION	DIMS	MCO	CAB	FINISH	SLP
441-12VSBSC-1	Vanity Organizer for 24"	8-1/2" (216 mm) W x 18-25/32" (478 mm) D x 18-7/8" (480 mm) H	9-1/4" (235 mm)	VSB24	Maple	\$395.85
441-15VSBSC-1	Vanity Organizer for 36"	11-21/32" (297 mm) W x 18-25/32" (478 mm) D x 18-7/8" (480 mm) H	12-5/32" (309 mm)	VSB30	Maple	\$479.95

Vanity Storage Rack

4VR Series



4VR-12-1

- Designed for 12", 15", 18", 21" and 24" vanity base cabinets
- Natural maple frame with semi-gloss finish
- (2) non-skid vinyl shelves with acrylic accents
- Mounts to cabinet door
- Patented adjustable door mount brackets provide up to 5" of adjustability (US Patent No. 7,204,569)
- TSCA Title VI compliant



Patented adjustable mounting brackets (US Patent No. 7,204,569)



4VR-18-1
Vanity Storage Rack
(18" version shown)

Door Mount Vanity Storage Rack

PRODUCT	DESCRIPTION	DIMS	MCO	CAB	FINISH	SLP
4VR-12-1	Storage Rack for 12"	8-1/4" (210 mm) W x 3-1/8" (80 mm) D x 15-1/2" (394 mm) H	9" (229 mm)	VB12	Maple	\$101.50
4VR-15-1	Storage Rack for 15"	11-1/4" (286 mm) W x 3-1/8" (80 mm) D x 15-1/2" (394 mm) H	12" (305 mm)	VB15	Maple	\$107.30
4VR-18-1	Storage Rack for 18"	14-1/4" (362 mm) W x 3-1/8" (80 mm) D x 15-1/2" (394 mm) H	15" (381 mm)	VB18	Maple	\$121.80

8-010/8-700 Series

Undersink Waste Containers

8-010

- Designed for 33" and 36" sink base cabinets or 24" single door sink base cabinets
- Single black polymer container with built-in handle, 14 or 15 L
- Stainless steel or white lacquer finish
- Lid rises as container pivots out
- Mounts to cabinet door, floor and side walls

8-700

- Designed for full access 36" sink base cabinets
- Single white polymer bin with built-in handle, 20 L
- Lid rises as container pivots out
- Mounts to cabinet door and side walls



8-010314-15



8-010212-14

14 L Container

(White lacquer finish shown)



8-010412-15

15 L Container, White

(White lacquer finish shown)



8-700411-20

20 L Sink Base Container

(White polymer finish shown)

Undersink Waste Container Pivot Outs

PRODUCT	DESCRIPTION	DIMS	MCO	CAB	FINISH	SLP
8-010212-14	Single 14 L	11" (280 mm) W x 10-1/2" (267 mm) D x 17-1/8 - 11" (435 - 280 mm) H	13-3/4" (350 mm)	VS33	White Lacquered	\$117.45
8-010412-15	Single 15 L	11-3/4" (299 mm) W x 10-1/2" (267 mm) D x 15-3/16" (386 mm) H	14-3/4" (375 mm) - FF 14-3/4" (375 mm) - FL	VS33	White Lacquered	\$129.05
8-010314-15	Single 15 L	11-3/4" (299 mm) W x 10-1/2" (267 mm) D x 15-3/16" (386 mm) H	14-3/4" (375 mm) - FF 14-3/4" (375 mm) - FL	VS33	Stainless Steel	\$158.05
8-700411-20	Single 20 L	15-3/4" (401 mm) W x 7-1/4" (185 mm) D x 18" (458 mm) H	17-1/2" (445 mm)	VS33	White Polymer	\$201.55

Chrome Universal Waste Pullout

RUKD Series



RUKD-820-1



RUKD-1432RB-1
Single 32 qt. Waste Container
w/ Rear Basket

- Designed for 12" and 18" base cabinet*
- Universal frame configuration
- Single 20 and 32 qt. polymer containers, gray
- Chrome-plated welded wire frame
- Full-extension, ball-bearing slides
- Clip-on handle
- RB versions come with a rear storage basket
- 4-screw installation
- Mounts to cabinet floor
- RV DM17 KIT door-mount kit (sold separately)

* Can be installed in sink base applications

Chrome Universal Waste Pullout

PRODUCT	DESCRIPTION	DIMS	MCO	CAB	FINISH	SLP
RUKD-820-1	Single 20 qt.	8-5/8" (219 mm) W x 15-3/4" (400 mm) D x 16-5/8" (422 mm) H 14-1/2" (368 mm) W x 15-3/4" (400 mm) D x 16-5/8" (422 mm) H	8-1/2" (216 mm) 14-1/2" (368 mm)	B12 B18	Gray/Chrome	\$102.95
RUKD-1420RB-1	Single 20 qt. w/ Rear Basket	14-1/2" (368 mm) W x 15-3/4" (400 mm) D x 16-5/8" (422 mm) H	14-1/2" (368 mm)	B18	Gray/Chrome	\$108.75
RUKD-932-1	Single 32 qt.	9-3/8" (238 mm) W x 15-3/4" (400 mm) D x 19-1/2" (495 mm) H 14-1/2" (368 mm) W x 16-7/16" (418 mm) D x 19-1/2" (495 mm) H	9-1/2" (241 mm) 14-1/2" (368 mm)	B12	Gray/Chrome	\$105.85
RUKD-1432RB-1	Single 32 qt. w/ Rear Basket	14-1/2" (368 mm) W x 16-7/16" (418 mm) D x 19-1/2" (495 mm) H	14-1/2" (368 mm)	B18	Gray/Chrome	\$113.85

Accessories

RV DM17 KIT	Heavy-Duty Door Mount Kit	Chrome	\$39.15
-------------	---------------------------	--------	---------

Aluminum Bottom Mount Rev-A-Motion®

5149 Series



5149-15DM18-117



- Designed for 15" base height vanity cabinets
- Single 35 qt. polymer containers, metallic silver or white
- Anodized aluminum frame, metallic silver or white base
- Full-extension with 1-1/2" over-travel, ball-bearing slides w/ Rev-A-Motion® soft-open/soft-close (US Patent No. 8,091,971)
- Patented door-mount brackets with 5" of adjustability (US Patent No. 8,939,526)



See page 37 for more information

Aluminum Bottom Mount Waste Container Pullout w/ Rev-A-Motion® - Reduced Depth

PRODUCT	DESCRIPTION	DIMS	MCO	CAB	FINISH	SLP
5149-15DM18-111	Single 35 qt.	12-1/8" (308 mm) W x 16" (407 mm) D x 19-1/2" (496 mm) H	11-1/2" (292 mm) - FF/ 12-1/4" (311 mm) - FL	VB15	White/Alum	\$408.90
5149-15DM18-117	Single 35 qt.	12-1/8" (308 mm) W x 16" (407 mm) D x 19-1/2" (496 mm) H	11-1/2" (292 mm) - FF/ 12-1/4" (311 mm) - FL	VB15	Silver/Alum	\$408.90

4SOWC Series

- Designed for 30" vanity base cabinets
- Single 8 L polymer container, metallic silver
- Natural maple dovetail frame with semi-gloss finish
- Mounts to cabinet door
- Patented adjustable door-mount brackets provide up to 5" of adjustability (US Patent No. 7,204,569)
- (1) white lid
- TSCA Title VI compliant

Door Mount Vanity Waste Container



Door Mount Vanity Waste Container

PRODUCT	DESCRIPTION	DIMS	MCO	CAB	FINISH	SLP
4SOWC-8-1	Single 8 L	10-3/8" (264 mm) W x 7-3/8" (188 mm) D x 12-5/16" (313 mm) H	12" (305 mm)	VSB30	Silver	\$92.80

4WCSC Series

- Designed for 30" vanity sink base cabinets and 15" base vanity cabinets
- Single 32 and 35 qt. polymer container, gray (32 qt. only) or metallic silver
- Natural maple dovetail frame with semi-gloss finish
- Full-extension, undermount slides w/ BLUM soft-close
- Mounts to cabinet door and floor
- Patented door-mount brackets with 5" of adjustability and micro-trim adjuster (US Patent No. 8,388,076)
- Rear storage
- 35 qt. polymer lids available (sold separately)
- TSCA Title VI compliant

Reduced Depth Bottom Mount Waste Container



4WCSC-1535DM19-1
Single 35 qt. Waste Container,
Reduced Depth
(Metallic silver/maple finish shown)



4WCSC-1532DM16-1

Reduced Depth Bottom Mount Waste Container w/ BLUM Soft-Close

PRODUCT	DESCRIPTION	DIMS	MCO	CAB	FINISH	SLP
4WCSC-1532DM16-1	Single 32 qt.	12" (305 mm) W x 15-21/32" (399 mm) D x 19-1/2" (496 mm) H	12" (305 mm)	VB15	Gray/Maple	\$378.45
4WCSC-1535DM19-1	Single 35 qt.	12" (305 mm) W x 18-21/32 - 18-5/8" (474 - 474 mm) D x 19-1/2" (496 mm) H	12" (305 mm)	VB15	Metallic Silver/Maple	\$413.25

Bottom Mount Wood Hamper

4WH Series



4WH-VCSC-21DM-1

- Designed for face frame 24" vanity base cabinets
- Single 1.5 BU polymer hamper, white
- Natural maple frame with semi-gloss finish
- Full-extension concealed slides w/ BLUM soft-close
- Mounts to cabinet door and floor
- (1) matching lid
- TSCA Title VI compliant



Scan for video

See closet section (page 296) for more hampers

1.5 BU Bottom Mount Hamper Pullout w/ BLUM Soft-Close

PRODUCT	DESCRIPTION	DIMS	MCO	CAB	FINISH	SLP
4WH-VCSC-21DM-1	Hamper Pullout	20-5/16" (516 mm) W x 18-11/16" (475 mm) D x 21-1/4" (540 mm) H	21" (533 mm)	VB24	Maple	\$462.55

Accessories

HPB-03323-52	Replacement Hamper				Polymer	\$49.30
--------------	--------------------	--	--	--	---------	---------

4VHTM Series

Top Mount Wood Hamper

- Designed for face frame 18" vanity height and base height vanity cabinets
- Single 1.5 BU polymer hamper w/ lid, white
- Natural maple frame with semi-gloss finish
- Full-extension w/ 2" over-travel, ball-bearing slides
- Mounts to cabinet door, rear and side walls
- Adjustable rear mount brackets and pre-assembled door-mount brackets
- TSCA Title VI compliant



4VHTM-1520DM-1

See closet section (page 296) for more hampers

*Replacement lid Part No: SP-HPB-LID

Maple Top Mount Pullout Hamper

PRODUCT	DESCRIPTION	DIMS	MCO	CAB	FINISH	SLP
4VHTM-1520DM-1	1.5 BU Hamper	15" (381 mm) W x 19-7/8" (505 mm) D x 20" (508 mm) H	15" (381 mm)	VB18	White/Maple	\$198.65
HPB-03323-52	Replacement Hamper	14" (356 mm) W x 18-5/8" (473 mm) D x 18-1/4" (464 mm) H (no lid)*			Polymer	\$49.30

Steel Top Mount Hamper

53TMVH Series



- Designed for full access 24" vanity base cabinets with 5/8" or 3/4" side walls
- Double .85 BU polymer containers, gray and white
- Powder-coated metal frame, white
- Door mount brackets
- Full-extension slides w/ soft-close
- Mounts to cabinet door and side walls
- Pre-assembled door-mount brackets
- (1) gray and (1) white lid

53TMVH-24SCDM-2-FL



53TMVH-24SCDM-2-FL
.85 BU Hamper

See closet section (page 296) for more hampers

Steel Top Mount Vanity Hamper Pullout w/ Soft-Close

PRODUCT	DESCRIPTION	DIMS	MCO	CAB	FINISH	SLP
53TMVH-24SCDM-2-FL	Top Mount Hamper	22-1/8" (562 mm) W x 21-21/32" (550 mm) D x 19-1/16" (485 mm) H	22-1/8" (562 mm)	FLFHV824	White/Gray/Steel	\$507.50

- Designed for face frame 18" vanity height and base height vanity cabinets
- Single 1.5 BU polymer hamper, white
- 4-screw installation
- Powder-coated white wire frame
- Full-extension, ball-bearing slides
- Mounts to cabinet floor
- Door-mount kit available (sold separately)



HPRV-1520 S



HPRV-1520 S
1.5 BU Hamper

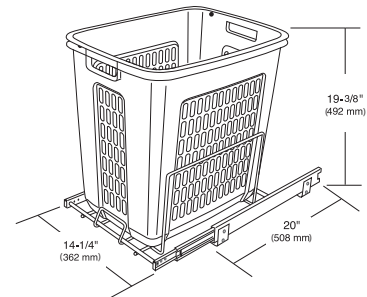

See closet section (page 296) for more hampers

Polymer Bottom Mount Hamper Pullout

PRODUCT	DESCRIPTION	DIMS	MCO	CAB	FINISH	SLP
HPRV-1520 S	1.5 BU Hamper	14-1/4" (362 mm) W x 20" (508 mm) D x 19-3/8" (493 mm) H	14-1/2" (368 mm)	VB18	White/Aluminum	\$160.95

Accessories

HPB-03323-52	Replacement Hamper	14" (356 mm) W x 18-5/8" (473 mm) D x 18-1/4" (464 mm) H			Polymer	\$49.30
RV DM KIT	Heavy Duty Door Mount Kit				White	\$39.15

Wire Bottom Mount Hamper

HRV Series



HRV-1520 S CR

- Designed for 15" and 18" vanity cabinets
- Single 1- 1.7 BU wire hampers
- 4-screw installation
- Chrome-plated or powder-coated white wire frame
- Full-extension, ball-bearing slides
- Mounts to cabinet floor
- (1) 1.7 BU machine washable canvas liner included with HRV-1520 S CR
- Door-mount kit available (sold separately)



HRV-1215 S
1 BU Hamper



HRV-1515 S
1.3 BU Hamper

See closet section (page 296) for more hampers

Wire Bottom Mount Hamper Pullout

PRODUCT	DESCRIPTION	DIMS	MCO	CAB	FINISH	SLP
HRV-1215 S	1.0 BU Hamper	11-7/8" (302 mm) W x 18" (458 mm) D x 14-3/4" (375 mm) H	11-1/2" (292 mm) - FF 12" (305 mm) - FL	VB15	White	\$204.45
HRV-1220 S	1.4 BU Hamper	11-7/8" (302 mm) W x 18" (458 mm) D x 19-3/8" (493 mm) H	11-3/4" (298 mm) - FF 12" (305 mm) - FL	VB15	White	\$204.45
HRV-1515 S	1.3 BU Hamper	14-3/4" (375 mm) W x 18" (458 mm) D x 14-3/4" (375 mm) H	14-1/2" (368 mm) - FF 14-3/4" (375 mm) - FL	VB18	White	\$210.25
HRV-1520 S	1.7 BU Hamper	14-3/4" (375 mm) W x 18" (458 mm) D x 19-3/8" (493 mm) H	14-1/2" (368 mm) - FF 14-3/4" (375 mm) - FL	VB18	White	\$221.85

Wire Bottom Mount Hamper Pullout w/ Canvas Liner

HRV-1520 S CR	1.7 BU Hamper	14-3/4" (375 mm) W x 18" (458 mm) D x 19-3/8" (493 mm) H	14-1/2" (368 mm) - FF 14-3/4" (375 mm) - FL	VB18	Chrome	\$227.65
---------------	---------------	--	--	------	--------	----------

Accessories

HRV-1520-LINER	1.7 BU Replacement Liner				Tan	\$44.95
RV DM KIT	Heavy Duty Door Mount Kit				White	\$39.15

NOTE: Only HRV-1520 S CR includes (1) liner



5190 Series

Aluminum Bottom Mount Canvas Hamper



- Designed for 18" base height vanity cabinets
- Single 2.1 BU canvas liner, tan (machine washable)
- Anodized aluminum frame, metallic silver or white base
- Full-extension with 1-1/2" over-travel, ball-bearing slides w/ Rev-A-Motion® soft-open/soft-close (US Patent No. 8,091,971)
- Mounts to cabinet door and floor
- Patented door-mount brackets with 5" of adjustability (US Patent No. 8,939,526)



5190-15RM-117

See closet section (page 296) for more hampers

Aluminum Bottom Mount Canvas Hamper w/ Rev-A-Motion®

PRODUCT	DESCRIPTION	DIMS	MCO	CAB	FINISH	SLP
5190-15RM-117	2.1 BU Canvas Hamper w/ Silver Base	14-5/16" (364 mm) W x 18-1/32" (458 mm) D x 19-11/32" (491 mm) H	14-1/2" (368 mm)	VB18	Silver/Tan	\$536.50

Accessories

5190-LINER	Canvas Liner Replacement	12" (305 mm) W x 18" (458 mm) D x 16" (407 mm) H			Tan	\$46.40
------------	--------------------------	--	--	--	-----	---------

Aluminum Bottom Mount Wire Hampers

CH Series



CH-241419-RM-217

- Designed for 27" base height vanity cabinets
- Double 1.2 BU wire hampers, with (2) canvas liners, machine washable
- Anodized aluminum frame, metallic silver
- Full-extension with 1-1/2" over-travel, ball-bearing slides w/ Rev-A-Motion® soft-open/soft-close (US Patent No. 8,091,971)
- Mounts to cabinet door and floor
- Patented door-mount brackets with 5" of adjustability (US Patent No. 8,939,526)



CH-241419-RM-217
Double 1.2 BU Hampers
w/ Silver Base

See closet section (page 296) for more hampers



Scan for video

Aluminum Bottom Mount Wire Hamper w/ Rev-A-Motion®

PRODUCT	DESCRIPTION	DIMS	MCO	CAB	FINISH	SLP
CH-241419-RM-217	Double 1.2 BU Hampers w/ Silver Base	24" (610 mm) W x 13-15/16" (355 mm) D x 18-7/8" (480 mm) H	24" (610 mm)	VB27	Silver/Tan	\$710.50
Accessories						
5CHB-Liner	(1) Replacement Canvas Liner				Tan	\$29.00

4WH Series

Bottom Mount Rev-A-Motion®

- Designed for 18" full height vanity and base height vanity cabinets
- Single 1.5 BU polymer hamper w/ lid, white
- Natural maple frame with semi-gloss finish
- Full-extension with 1-1/2" over-travel, ball-bearing slides w/ Rev-A-Motion® soft-open/soft-close (US Patent No. 8,091,971)
- Mounts to cabinet door and floor
- Pre-assembled door-mount brackets
- TSCA Title VI compliant



4WH-RM-15DM-1

US PATENT NO: 8,091,971



See closet section (page 296) for more hampers

*Replacement lid Part No: SP-HPB-LID

Bottom Mount Hamper Pullout w/ Rev-A-Motion®

PRODUCT	DESCRIPTION	DIMS	MCO	CAB	FINISH	SLP
4WH-RM-15DM-1	1.5 BU Hamper	14-1/4" (362 mm) W x 19-3/4" (502 mm) D x 21" (534 mm) H	14-1/2" (381 mm) - FF 14-1/2" (381 mm) - FL	FHVB18	White/Maple	\$492.25
HPB-03323-52	Replacement Hamper	14" (356 mm) W x 18-5/8" (473 mm) D x 18-1/4" (464 mm) H (no lid)*			Polymer	\$49.30

Pullout Vanity Fillers

432-VF Series



432-VF26SC-6



- Designed for 3" and 6" vanity filler applications
- Natural maple frame with semi-gloss finish
- Full-extension, undermount slides w/ BLUM soft-close
- Patented undermount soft-close slide system (US Patent No. 8,733,865)
- Mounts between cabinets
- Adjustable shelves with clear rails and non-skid vinyl lining
- (4) or (6) polycarbonate bins
- TSCA Title VI compliant



432-VF30SC-3

3" Vanity Base Height Filler w/ (6) Bins

NOTE: Polycarbonate Bins = 7" (178 mm) W x 1-3/4" (45 mm) D x 2-1/4" (57 mm) H

Vanity Filler Pullout w/ BLUM Soft-Close

PRODUCT	DESCRIPTION	DIMS	FINISH	SLP
432-VF26SC-3	3" Vanity Filler w/ (4) Bins	3" (77 mm) W x 19" (483 mm) D x 26" (661 mm) H	Maple	\$421.95
432-VF26SC-6	6" Vanity Filler w/ (4) Bins	6" (153 mm) W x 19" (483 mm) D x 26" (661 mm) H	Maple	\$508.95
432-VF30SC-3	3" Vanity Base Height Filler w/ (6) Bins	3" (77 mm) W x 19" (483 mm) D x 30" (762 mm) H	Maple	\$479.95
432-VF30SC-6	6" Vanity Base Height Filler w/ (6) Bins	6" (153 mm) W x 19" (483 mm) D x 30" (762 mm) H	Maple	\$566.95

445 Series

Grooming Organizer



- Designed for face frame 12" vanity cabinets with full height door
- Natural maple frame with semi-gloss finish
- Full-extension, undermount slides w/ BLUM soft-close
- Mounts to cabinet door and floor
- Patented door-mount brackets provide 5" of adjustability and include micro-trim adjuster (US Patent No. 8,388,076)
- Adjustable shelves with clear rails and non-skid vinyl lining
- (2) stainless steel bins
- Patented design (US Patent No. D596,424)
- TSCA Title VI compliant



445-VCG25SC-8



445-VCG20SC-8
8" Vanity Grooming Organizer

Grooming Organizer Pullout w/ BLUM Soft-Close

PRODUCT	DESCRIPTION	DIMS	MCO	CAB	FINISH	SLP
445-VCG20SC-8	8" Vanity Grooming Organizer	8-7/16" (215 mm) W x 19-9/16" (497 mm) D x 20-3/8" (518 mm) H	9" (227 mm)	FHVB12	Wood	\$436.45
445-VCG25SC-8	8" Base Height Vanity Grooming Organizer	8-7/16" (215 mm) W x 19-9/16" (497 mm) D x 25-9/16" (650 mm) H	9" (227 mm)	FHVB12	Wood	\$522.00

Vanity Tiered Organizer

448 Series



- Designed for face frame 12" vanity cabinets with full height door
- Natural maple frame with semi-gloss finish
- Full-extension, undermount slides w/ BLUM soft-close
- Mounts to cabinet door and floor
- Patented door-mount brackets provide 5" of adjustability and include micro-trim adjuster (US Patent No. 8,388,076)
- Adjustable shelves with clear rails and non-skid vinyl lining
- (6) or (9) polycarbonate bins
- Patented mounting straps (US Patent No. 9,756,941)
- TSCA Title VI compliant

448-VC25SC-8



448-VC25SC-8
8" Base Height Vanity Organizer
w/ (9) Bins

Tiered Vanity Organizer Pullout w/ BLUM Soft-Close

PRODUCT	DESCRIPTION	DIMS	MCO	CAB	FINISH	SLP
448-VC20SC-8	8" Vanity Organizer w/ (6) Bins	8-7/16" (215 mm) W x 19-9/16" (497 mm) D x 20-3/8" (518 mm) H	8-1/2" (216 mm) - FF 8-1/2" (216 mm) - FL	FHVB12	Wood	\$595.95
448-VC25SC-8	8" Base Height Vanity Organizer w/ (9) Bins	8-7/16" (215 mm) W x 19" (483 mm) D x 25-9/16" (650 mm) H	8-1/2" (216 mm) - FF 8-1/2" (216 mm) - FL	FHVB12	Wood	\$682.95

NOTE: Polycarbonate Bins = 7" (178 mm) W x 1-3/4" (45 mm) D x 2-1/4" (57 mm) H

SBVDTF-Series

Flexible Vanity Drip Tray

- Designed for 27" to 42" sink base cabinets
- Flexible, durable and easy-to-clean TPE construction, gray
- Trimmable
- Drop-in installation
- Funnels excess water out of the front of your cabinet
- Can be installed in existing cabinet construction



SBVDTF-3336-14-1



Flexible, durable, and easy-to-clean
TPE construction, gray



Funnels excess water out of the
front of your cabinet

See sink section page 84 for sink base version

Flexible Drip Tray

PRODUCT	DESCRIPTION	DIMS	CAB	FINISH	SLP
SBVDTF-2124-14-1	Drip Tray	22-1/2" (572 mm) W x 20-1/4" (515 mm) D x 3/4" (19 mm) H	VSB-24-27	Gray	\$58.00
SBVDTF-2730-14-1	Drip Tray	28-1/2" (724 mm) W x 20-1/4" (515 mm) D x 3/4" (19 mm) H	VSB-27-30	Gray	\$63.65
SBVDTF-3336-14-1	Drip Tray	34-1/2" (876 mm) W x 20-1/4" (515 mm) D x 3/4" (19 mm) H	VSB-33-36	Gray	\$70.35

Vanity Drip Tray

SBVDT Series



- Designed for installation in new 24" to 36" vanity sink base cabinets
- Glossy polystyrene construction, almond or metallic silver
- Drop-in installation
- Protects the bottom of your cabinet from water damage
- Recommended for new construction only

SBVDT-2730-A-1



S: Metallic Silver, A: Almond

See sink section page 85 for sink base version

Tray Capacity	
SBVDT-2124	7/8 qt.
SBVDT-2730	1-1/4 qt.
SBVDT-3336	1-1/2 qt.

Vanity Drip Tray

PRODUCT	DESCRIPTION	DIMS	MIN TRIM	FINISH	SLP
SBVDT-2124-A-1	Drip Tray	22-1/2" (572 mm) W x 20-1/4" (515 mm) D x 3/4" (20 mm) H	19-1/2" (495 mm) W x 18-1/2" (470 mm) D	Almond	\$58.75
SBVDT-2124-S-1	Drip Tray	22-1/2" (572 mm) W x 20-1/4" (515 mm) D x 3/4" (20 mm) H	19-1/2" (495 mm) W x 18-1/2" (470 mm) D	Metallic Silver	\$61.65
SBVDT-2730-A-1	Drip Tray	28-1/2" (724 mm) W x 20-1/4" (515 mm) D x 3/4" (20 mm) H	25-1/2" (648 mm) W x 18-1/2" (470 mm) D	Almond	\$65.10
SBVDT-2730-S-1	Drip Tray	28-1/2" (724 mm) W x 20-1/4" (515 mm) D x 3/4" (20 mm) H	25-1/2" (648 mm) W x 18-1/2" (470 mm) D	Metallic Silver	\$67.40
SBVDT-3336-A-1	Drip Tray	34-1/2" (876 mm) W x 20-1/4" (515 mm) D x 3/4" (20 mm) H	31-1/2" (800 mm) W x 18-1/2" (470 mm) D	Almond	\$72.50
SBVDT-3336-S-1	Drip Tray	34-1/2" (876 mm) W x 20-1/4" (515 mm) D x 3/4" (20 mm) H	31-1/2" (800 mm) W x 18-1/2" (470 mm) D	Metallic Silver	\$73.95

(12) Vanity Drip Trays

SBVDT-2124-A-12	(12) Drip Trays	22-1/2" (572 mm) W x 20-1/4" (515 mm) D x 3/4" (20 mm) H	19-1/2" (495 mm) W x 18-1/2" (470 mm) D	Almond	\$53.65 ea.
SBVDT-2124-S-12	(12) Drip Trays	22-1/2" (572 mm) W x 20-1/4" (515 mm) D x 3/4" (20 mm) H	19-1/2" (495 mm) W x 18-1/2" (470 mm) D	Metallic Silver	\$58.45 ea
SBVDT-2730-A-12	(12) Drip Trays	28-1/2" (724 mm) W x 20-1/4" (515 mm) D x 3/4" (20 mm) H	25-1/2" (648 mm) W x 18-1/2" (470 mm) D	Almond	\$52.90 ea
SBVDT-2730-S-12	(12) Drip Trays	28-1/2" (724 mm) W x 20-1/4" (515 mm) D x 3/4" (20 mm) H	25-1/2" (648 mm) W x 18-1/2" (470 mm) D	Metallic Silver	\$63.80 ea
SBVDT-3336-A-12	(12) Drip Trays	34-1/2" (876 mm) W x 20-1/4" (515 mm) D x 3/4" (20 mm) H	31-1/2" (800 mm) W x 18-1/2" (470 mm) D	Almond	\$63.80 ea
SBVDT-3336-S-12	(12) Drip Trays	34-1/2" (876 mm) W x 20-1/4" (515 mm) D x 3/4" (20 mm) H	31-1/2" (800 mm) W x 18-1/2" (470 mm) D	Metallic Silver	\$69.30 ea

5SBWC Series

- Designed for 24" and larger sink base cabinets
- (1) 8 L and (1) 15 L bin, both with handles
- Full-extension, undermount slides w/ soft-close
- Mounts to cabinet floor
- (1) green lid and (1) white lid
- Door-mounting kit (sold separately)



Scan for video

Sink Base Waste Pullout



5SBWC-815S-1

Wire Undersink Waste Pullout

PRODUCT	DESCRIPTION	DIMS	MCO	CAB	FINISH	SLP
5SBWC-815S-1	(1) 8 L and (1) 15 L Bin	8-15/16" (228 mm) W x 18-19/32" (473 mm) D x 14-1/4" (362 mm) H	9" (227 mm)	VSB24+	Silver	\$173.30

Accessories

5WB-DMKIT	Door Mount Kit				Chrome	\$39.15
-----------	----------------	--	--	--	--------	---------

5SBWCC Series

- Designed for 24" and larger sink base cabinets
- (1) 8 L with removable rack and (2) 1 L spray bottles
- Full-extension, undermount slides w/ soft-close
- Mounts to cabinet floor
- (1) green lid
- Door-mounting kit (sold separately)



Scan for video

Sink Base Waste & Cleaning Pullout



5SBWCC-815S-1

Wire Undersink Waste & Cleaning Pullout

PRODUCT	DESCRIPTION	DIMS	MCO	CAB	FINISH	SLP
5SBWCC-815S-1	(1) 8 L and (2) 1 L Bottles	8-15/16" (228 mm) W x 18-19/32" (473 mm) D x 14-1/4" (362 mm) H	9" (227 mm)	VSB24+	Silver	\$152.25

Accessories

5WB-DMKIT	Door-Mount Kit				Chrome	\$39.15
-----------	----------------	--	--	--	--------	---------