



LAZY SUSAN

Standing the test of time, our Lazy Susan line is revered as the best in the industry with exceptional quality, unfaltering durability and premium selection! Our extensive collection of Lazy Susans includes Full-Circle, Kidney-Shaped, D-Shaped, Pie-Cut and Half-Moon designs to accommodate any cabinet shape. With sizes ranging from 10" to 32" and your choice of polymer, wood or wire, you are sure to find the perfect Susan for any cabinet size or style. The bottom line - we know Lazy Susans! Next time you are specifying a Lazy Susan, call on the brand you can trust for superior quality and the brand that started it all: Rev-A-Shelf®!

Innovation through Organization™

Waste

Blind Corner

Sink

Base

Tall

Drawer

Wall

Vanity

Closet

Lazy Susan

Lighting

Lazy Susan

Polymer Lazy Daisy

- Unique patented snap pin design
- Ribbed tray surface
- Molded polymer hubs
- Independently rotating
(Not applicable on pie cut)
- Almond and white
- Polypropylene material
- US Patent No.'s 7,922,016 and 8,528,873

Our Polymer Lazy Daisy Lazy Susans are tested to exceed BHMA Class II Specs: 15 lbs per square foot at 50k cycles

All of our Lazy Susans are manufactured using high quality materials and are backed by a limited Lifetime Warranty. We have developed a tiered category system (Good, Better, Best) that will allow you to quickly identify which configuration will give you the features you want, with the value you require.



Good



Tray Configurations

Call for Bulk Pricing 800-626-1126

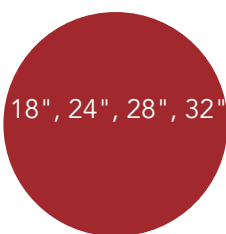

18", 24", 28", 32"

Full-Circle



32"

D-Shaped

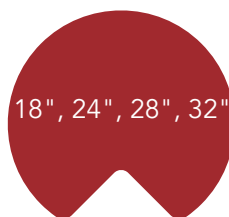

18", 24", 28", 32"

Kidney-Shaped

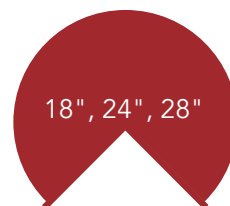

18", 24", 28"

Pie-Cut

See Page 323 for Hardware

** Insert "11" for White or "15" for Almond finish



FULL-CIRCLE SHELF

Bottom Mount Polymer Lazy Daisy w/ Hardware

PRODUCT	DESCRIPTION	DIMS	FINISH	SLP
LD-2061-18BM-**-1	Single Shelf	18" Diameter (457 mm)	Polymer	\$47.85
LD-2061-24BM-**-1	Single Shelf	24" Diameter (610 mm)	Polymer	\$53.65
LD-2061-28BM-**-1	Single Shelf	28" Diameter (711 mm)	Polymer	\$59.45
LD-2061-32BM-**-1	Single Shelf	32" Diameter (813 mm)	Polymer	\$79.75

(2) Shelf Bottom Mount Polymer Lazy Daisy w/ Hardware

LD-2062-18BM-**-1	(2) Shelf Set	18" Diameter (457 mm)	Polymer	\$73.95
LD-2062-24BM-**-1	(2) Shelf Set	24" Diameter (610 mm)	Polymer	\$91.35
LD-2062-28BM-**-1	(2) Shelf Set	28" Diameter (711 mm)	Polymer	\$94.25
LD-2062-32BM-**-1	(2) Shelf Set	32" Diameter (813 mm)	Polymer	\$124.40

(2) Shelf Polymer Lazy Daisy w/ 26"-31" Telescoping Post

LD-2062-18-**-1	(2) Shelf Set	18" Diameter (457 mm)	Polymer	\$76.85
LD-2062-24-**-1	(2) Shelf Set	24" Diameter (610 mm)	Polymer	\$94.25
LD-2062-28-**-1	(2) Shelf Set	28" Diameter (711 mm)	Polymer	\$97.15
LD-2062-32-**-1	(2) Shelf Set	32" Diameter (813 mm)	Polymer	\$131.95

(3) Shelf Polymer Lazy Daisy w/ 34"-41" Telescoping Post

LD-2063-1836-**-1	(3) Shelf Set	18" Diameter (457 mm)	Polymer	\$105.85
-------------------	---------------	-----------------------	---------	----------

(Attaches to the cabinet door)



PIE-CUT SHELF

(2) Shelf Polymer Lazy Daisy w/ 26"-31" Telescoping Post

PRODUCT	DESCRIPTION	DIMS	FINISH	SLP
LD-2942-18-**-1	(2) Shelf Set	18" Diameter (457 mm)	Polymer	\$102.95
LD-2942-24-**-1	(2) Shelf Set	24" Diameter (610 mm)	Polymer	\$119.65
LD-2942-28-**-1	(2) Shelf Set	28" Diameter (711 mm)	Polymer	\$131.95

(Hinged door; not attached)



KIDNEY SHELF

(2) Shelf Polymer Lazy Daisy w/ 26"-31" Telescoping Post

PRODUCT	DESCRIPTION	DIMS	FINISH	SLP
LD-2472-18-**-1	(2) Shelf Set	18" Diameter (457 mm)	Polymer	\$72.50
LD-2472-24-**-1	(2) Shelf Set	24" Diameter (610 mm)	Polymer	\$87.00
LD-2472-28-**-1	(2) Shelf Set	28" Diameter (711 mm)	Polymer	\$102.95
LD-2472-32-**-1	(2) Shelf Set	32" Diameter (813 mm)	Polymer	\$123.25

(2) Shelf Bottom Mount Polymer Lazy Daisy w/ Hardware

LD-2472-18BM-**-1	(2) Shelf Set	18" Diameter (457 mm)	Polymer	\$68.15
LD-2472-24BM-**-1	(2) Shelf Set	24" Diameter (610 mm)	Polymer	\$94.95
LD-2472-28BM-**-1	(2) Shelf Set	28" Diameter (711 mm)	Polymer	\$94.95
LD-2472-32BM-**-1	(2) Shelf Set	32" Diameter (813 mm)	Polymer	\$123.25

(3) Shelf Bottom Mount Polymer Lazy Daisy w/ 34"-41" Telescoping Post

LD-2473-1836-**-1	(3) Shelf Set	18" Diameter (457 mm)	Polymer	\$107.30
-------------------	---------------	-----------------------	---------	----------



D-SHAPED SHELF

Bottom Mount Polymer Lazy Daisy w/ Hardware

PRODUCT	DESCRIPTION	DIMS	FINISH	SLP
LD-2261-32BM-**-1	Single Shelf	32" Diameter (813 mm)	Polymer	\$82.65

(2) Shelf Polymer Lazy Daisy w/ Hardware

LD-2262-32-**-1	(2) Shelf Set	32" Diameter (813 mm)	Polymer	\$143.55
-----------------	---------------	-----------------------	---------	----------

(2) Shelf Bottom Mount Polymer Lazy Daisy w/ Hardware

LD-2262-32BM-**-1	(2) Shelf Set	32" Diameter (813 mm)	Polymer	\$136.30
-------------------	---------------	-----------------------	---------	----------

SPECIFICATIONS

LAZY DAISY POLYMER SHELVES

Shelf	Material	Series	A	B	C	D	Post System
18" Kidney	Polymer	LD	1-1/8"	2"	11"	18"	25 mm IND./DEP.
24" Kidney	Polymer	LD	1-3/4"	2-3/4"	14-3/4"	24"	25 mm IND./DEP.
28" Kidney	Polymer	LD	3"	4-3/8"	18-3/8"	27-5/8"	25 mm IND./DEP.
32" Kidney	Polymer	LD	4"	6"	21-7/8"	31-3/4"	25 mm IND./DEP.

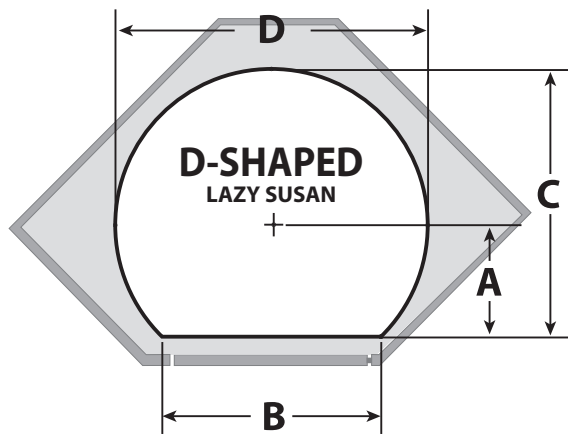
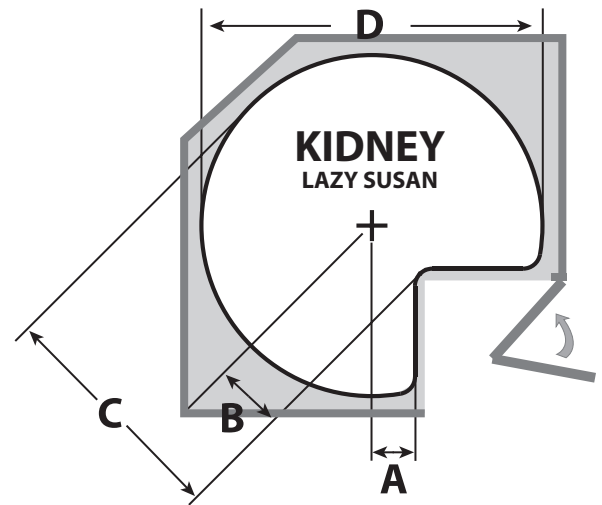

Shelf	Material	Series	A	B	C	D	Post System
32" D-Shaped	Polymer	LD	14"	14-3/4"	29-7/8"	31-3/4"	25 mm IND./DEP.

Shelf	Material	Series	A	B	C	D	Z
18" Pie-Cut	Polymer	LD	1-1/8"	1-5/8"	10-5/8"	18"	8" + 1/8" GAP
24" Pie-Cut	Polymer	LD	1-5/8"	2-3/8"	14-3/8"	24"	10-3/8" + 1/8" GAP
28" Pie-Cut	Polymer	LD	3"	4-1/4"	18"	27-5/8"	10-7/8" + 1/8" GAP

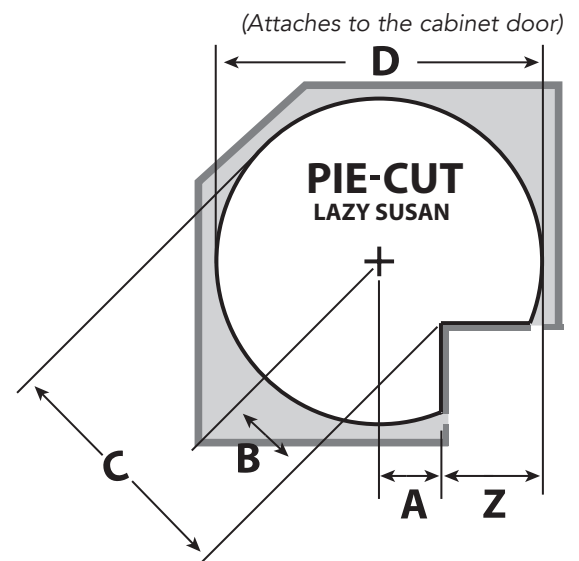

For custom applications, a trial installation is recommended.
Door edge profile, thickness and gaps all factor in installation.

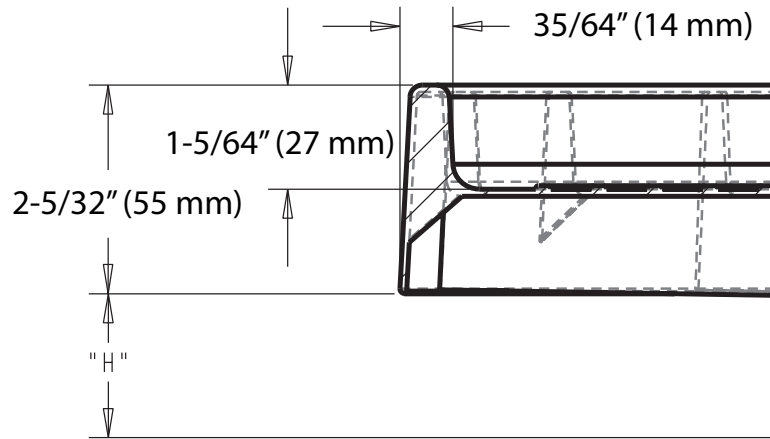

TOP OF CABINET FLOOR

Tray Shape	"H"
Full-Circle	1-19/32" (41 mm)
Kidney & D-Shaped	1-7/16" (37 mm)

WE HAVE
EVEN MORE
OPTIONS!LAZY
SUSANS

Call your salesperson or 800-626-1126
if you would like more information on

Custom Tray/Hardware Configurations

Pallet Program/Enviro Packaging:

Many of our Lazy Susans are available in pallet quantities:

- Volume pricing
- Reduced transportation cost
- Minimal storage space
- Environmentally conscious packaging



Lazy Susan

Polymer Value Line

- Twist-n-Lock telescoping post
- Molded polymer hubs
- Independently rotating
- Almond and white
- Polystyrene material

Our Lazy Susans are tested to exceed BHMA Class 1 Specs: 20 lbs. per square foot at 75K cycles.

All of our Lazy Susans are manufactured using high quality materials and are backed by a limited Lifetime Warranty. We have developed a tiered category system (Good, Better, Best) that will allow you to quickly identify which configuration will give you the features you want, with the value you require.



Better



Shelf	Material	Series	A	B	C	D	Post System
24" Kidney	Polymer	3400	1-1/2"	2-5/16"	14-5/16"	24"	1" Ind.
28" Kidney	Polymer	3400	3"	4-11/16"	18-5/8"	28"	1" Ind.
32" Kidney	Polymer	3400	4-1/4"	6-7/16"	22-7/16"	32"	1" Ind.

DEP.=DEPENDENTLY ROTATING SYSTEM
IND.=INDEPENDENTLY ROTATING SYSTEM

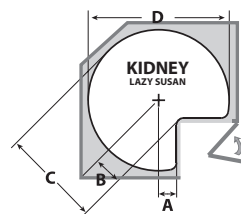

Tray Configurations

Call for Bulk Pricing 800-626-1126

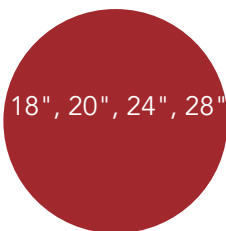

Full-Circle

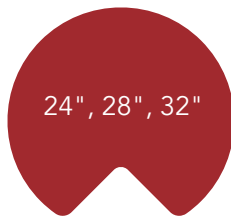

Kidney-Shaped

See Page 323 for Hardware



Twist-n-Lock Telescoping Post

FULL-CIRCLE SHELF



NOTE: ** Insert "11" for White or "15" for Almond finish

Value Line Lazy Susan w/ Hub -Must purchase bottom mount hardware to attach to cabinet

PRODUCT	DESCRIPTION	DIMS	FINISH	SLP
3071-18-**-52	Single Shelf	18" (457 mm) Diameter	Polymer	\$34.80
3071-20-**-52	Single Shelf	20" (508 mm) Diameter	Polymer	\$39.15
3071-24-**-52	Single Shelf	24" (610 mm) Diameter	Polymer	\$43.50
3071-28-**-52	Single Shelf	28" (711 mm) Diameter	Polymer	\$53.65

Bottom Mount Hardware

BM1-VL-04-52	Hardware	4-1/4" (108 mm) H	Zinc	\$26.95
--------------	----------	-------------------	------	---------

(2) Shelf Value Line Lazy Susan w/ 26"-31" (660-788 mm) Telescoping Post

3072-18-**-52	(2) Shelf Set	18" (457 mm) Diameter	Polymer	\$76.85
3072-20-**-52	(2) Shelf Set	20" (508 mm) Diameter	Polymer	\$85.55
3072-24-**-52	(2) Shelf Set	24" (610 mm) Diameter	Polymer	\$97.15
3072-28-**-52	(2) Shelf Set	28" (711 mm) Diameter	Polymer	\$111.65

(3) Shelf Value Line Lazy Susan w/ 31"-38" (788-965 mm) Telescoping Post

3073-18-**-531	(3) Shelf Set	18" (457 mm) Diameter	Polymer	\$119.65
3073-20-**-531	(3) Shelf Set	20" (508 mm) Diameter	Polymer	\$126.15

(3) Shelf Value Line Lazy Susan w/ 38"-46" (965-1169 mm) Telescoping Post

3073-18-**-536	(3) Shelf Set	18" (457 mm) Diameter	Polymer	\$122.50
3073-20-**-536	(3) Shelf Set	20" (508 mm) Diameter	Polymer	\$128.30

KIDNEY-SHAPED SHELF



(Hinged door; not attached)

Value Line Lazy Susan w/ Hub -Must purchase bottom mount hardware to attach to cabinet

PRODUCT	DESCRIPTION	DIMS	FINISH	SLP
3471-24-**-52	Single Shelf	24" (610 mm) Diameter	Polymer	\$40.60
3471-28-**-52	Single Shelf	28" (711 mm) Diameter	Polymer	\$50.75
3471-32-**-52	Single Shelf	32" (813 mm) Diameter	Polymer	\$59.45

Bottom Mount Hardware

BM1-VL-04-52	Hardware	4-1/4" (108 mm) H	Zinc	\$26.95
--------------	----------	-------------------	------	---------

(2) Shelf Value Line Lazy Susan w/ 26"-31" (660-788 mm) Telescoping Post

3472-24-**-52	(2) Shelf Set	24" (610 mm) Diameter	Polymer	\$98.60
3472-28-**-52	(2) Shelf Set	28" (711 mm) Diameter	Polymer	\$114.55
3472-32-**-52	(2) Shelf Set	32" (813 mm) Diameter	Polymer	\$129.05

LIP SPECIFICATIONS

VALUE LINE POLYMER SHELVES

WALL SHELVES

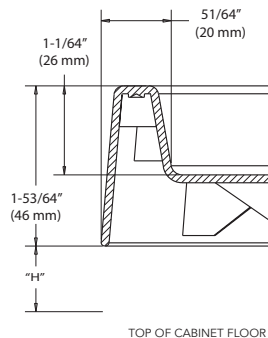
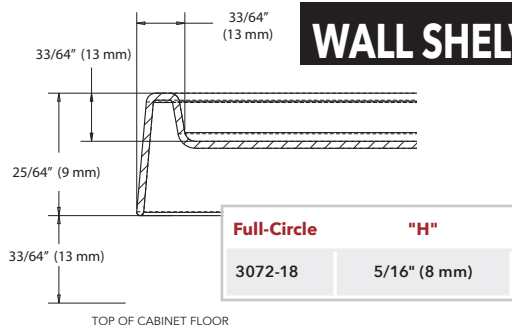

BASE SHELVES

Product	Lip Specification
3072-24 & 28	1-3/64" (27 mm)
3472-24, 28 & 32	1-3/64" (27 mm)

Lazy Susan

RAS Polymer

- Chrome post and hubs
- Independently and dependently rotating
- Almond and white
- Polystyrene material
- Tested to exceed BHMA Grade 1 standards

Our Lazy Susans are tested to exceed BHMA Class 1 Specs: 20 lbs. per square foot at 75K cycles.

All of our lazy susans are manufactured using high quality materials and are backed by a limited Lifetime Warranty. We have developed a tiered category system (Good, Better, Best) that will allow you to quickly identify which configuration will give you the features you want, with the value you require.



Best



Tray Configurations

Call for Bulk Pricing 800-626-1126

16", 18", 20",
24", 28", 32"

Full-Circle

20", 22"

D-Shaped

18", 24", 28", 32"

Kidney-Shaped

24", 28"

Pie-Cut

31", 33", 39"

Half-Moon

See Page 323 for Hardware

D-SHAPED SHELF

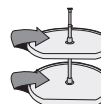

DEPENDENTLY ROTATING

(2) Shelf RAS Polymer Lazy Susan w/ 24"-31" (610-788 mm) Telescoping Post

PRODUCT	DESCRIPTION	DIMS	FINISH	SLP
7012-20-**-52	(2) Shelf Set	20" (508 mm) Diameter	Polymer	\$97.15

(3) Shelf RAS Polymer Lazy Susan w/ 38"-46" (965-1169 mm) Telescoping Post

7013-20-**-526	(3) Shelf Set	20" (508 mm) Diameter	Polymer	\$152.25
----------------	---------------	-----------------------	---------	----------

NOTES: 3/4" (19 mm) diameter post system. **7012** - Telescoping post dimensions 12" (305 mm) upper & 21" (534 mm) lower post. **7013** - Telescoping post dimensions 12" (305 mm) upper & 36" (915 mm) lower post. ** Available colors: 11 White, 15 Almond Tested to exceed BHMA Class 1 Specifications.

D-SHAPED SHELF

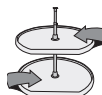

INDEPENDENTLY ROTATING

RAS Polymer Lazy Susan w/ Hub -Must purchase bottom mount hardware to attach to cabinet

PRODUCT	DESCRIPTION	DIMS	FINISH	SLP
6271-20-**-52	Single Shelf	20" (508 mm) Diameter	Polymer	\$49.30
6271-22-**-52	Single Shelf	22" (559 mm) Diameter	Polymer	\$59.45

Bottom Mount Hardware

BM1-04-52	Hardware	4-11/16" (119 mm) H	Zinc	\$33.35
BM1-18-52	Hardware for (2) Shelf Set	17-7/8" (454 mm) H	Zinc	\$52.05

Bottom Mount RAS Polymer Lazy Susan w/ Hardware

PRODUCT	DESCRIPTION	DIMS	FINISH	SLP
6221-20-**-52	Single Shelf	20" (508 mm) Diameter	Polymer	\$71.05
6221-22-**-52	Single Shelf	22" (559 mm) Diameter	Polymer	\$75.40

(2) Shelf RAS Polymer Lazy Susan w/ 26"-32" (660-813 mm) Telescoping Post

6272-20-**-52	(2) Shelf Set	20" (508 mm) Diameter	Polymer	\$168.20
6272-22-**-52	(2) Shelf Set	22" (559 mm) Diameter	Polymer	\$171.10

(3) Shelf RAS Polymer Lazy Susan w/ 38"-46" (965-1169 mm) Telescoping Post

6273-20-**-536	(3) Shelf Set	20" (508 mm) Diameter	Polymer	\$245.05
6273-22-**-536	(3) Shelf Set	22" (559 mm) Diameter	Polymer	\$250.85

KIDNEY-SHAPED SHELF

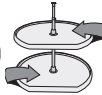

INDEPENDENTLY ROTATING

RAS Polymer Lazy Susan w/ Hub -Must purchase bottom mount hardware to attach to cabinet

PRODUCT	DESCRIPTION	DIMS	FINISH	SLP
6471-18-**-52	Single Shelf	18" (457 mm) Diameter	Polymer	\$53.20
6471-24-**-52	Single Shelf	24" (610 mm) Diameter	Polymer	\$65.25
6471-28-**-52	Single Shelf	28" (711 mm) Diameter	Polymer	\$76.85
6471-32-**-52	Single Shelf	32" (813 mm) Diameter	Polymer	\$82.65

Bottom Mount Hardware

BM1-04-52	Hardware	4-11/16" (119 mm) H	Zinc	\$39.15
BM1-18-52	Hardware for (2) Shelf Set	17-7/8" (454 mm) H	Zinc	\$52.05

Bottom Mount RAS Polymer Lazy Susan w/ Hardware

6421-18-**-52	Single Shelf	18" (457 mm) Diameter	Polymer	\$71.05
6421-24-**-52	Single Shelf	24" (610 mm) Diameter	Polymer	\$75.40
6421-28-**-52	Single Shelf	28" (711 mm) Diameter	Polymer	\$87.00
6421-32-**-52	Single Shelf	32" (813 mm) Diameter	Polymer	\$97.15

(2) Shelf RAS Polymer Lazy Susan w/ 26"-32" (660-813 mm) Telescoping Post

6472-18-**-52	(2) Shelf Set	18" (457 mm) Diameter	Polymer	\$110.20
6472-24-**-52	(2) Shelf Set	24" (610 mm) Diameter	Polymer	\$141.40
6472-28-**-52	(2) Shelf Set	28" (711 mm) Diameter	Polymer	\$166.75
6472-32-**-52	(2) Shelf Set	32" (813 mm) Diameter	Polymer	\$184.15

FULL-CIRCLE SHELF

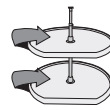

INDEPENDENTLY ROTATING

(2) Shelf RAS Polymer Lazy Susan w/ 24"-31" (610-788 mm) Telescoping Post

PRODUCT	DESCRIPTION	DIMS	FINISH	SLP
6012-18-**-52	(2) Shelf Set	18" (457 mm) Diameter	Polymer	\$83.40
6012-20-**-52	(2) Shelf Set	20" (508 mm) Diameter	Polymer	\$90.65
6012-24-**-52	(2) Shelf Set	24" (610 mm) Diameter	Polymer	\$102.95
6012-28-**-52	(2) Shelf Set	28" (711 mm) Diameter	Polymer	\$123.95

(3) Shelf RAS Polymer Lazy Susan w/ 38"-46" (965-1169 mm) Telescoping Post

6013-18-**-526	(3) Shelf Set	18" (457 mm) Diameter	Polymer	\$126.15
6013-20-**-526	(3) Shelf Set	20" (508 mm) Diameter	Polymer	\$137.75

NOTES: 3/4" (19 mm) diameter post system. **6012** - Telescoping post dimensions 12" (305 mm) upper & 21" (534 mm) lower post.

6013 - Telescoping post dimensions 12" (305 mm) upper & 36" (915 mm) lower post. Post length can be cut to accommodate inner cabinet heights of less than 38" (965 mm).

FULL-CIRCLE SHELF

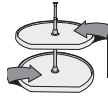

INDEPENDENTLY ROTATING

RAS Polymer Lazy Susan w/ Hub -Must purchase bottom mount hardware to attach to cabinet

PRODUCT	DESCRIPTION	DIMS	FINISH	SLP
6071-16-**-52	Single Shelf	16" (406 mm) Diameter	Polymer	\$50.75
6071-18-**-52	Single Shelf	18" (457 mm) Diameter	Polymer	\$52.20
6071-20-**-52	Single Shelf	20" (508 mm) Diameter	Polymer	\$54.40
6071-24-**-52	Single Shelf	24" (610 mm) Diameter	Polymer	\$60.90
6071-28-**-52	Single Shelf	28" (711 mm) Diameter	Polymer	\$71.05
6071-32-**-52	Single Shelf	32" (813 mm) Diameter	Polymer	\$82.65

Bottom Mount Hardware

BM1-04-52	Hardware	4-1/4" (108 mm) H	Zinc	\$33.35
-----------	----------	-------------------	------	---------

Bottom Mount RAS Polymer Lazy Susan w/ Hardware

PRODUCT	DESCRIPTION	DIMS	FINISH	SLP
6621-16-**-52	Single Shelf	16" (406 mm) Diameter	Polymer	\$68.90
6621-18-**-52	Single Shelf	18" (457 mm) Diameter	Polymer	\$70.35
6621-20-**-52	Single Shelf	20" (508 mm) Diameter	Polymer	\$71.75
6621-24-**-52	Single Shelf	24" (610 mm) Diameter	Polymer	\$80.45
6621-28-**-52	Single Shelf	28" (711 mm) Diameter	Polymer	\$97.15
6621-32-**-52	Single Shelf	32" (813 mm) Diameter	Polymer	\$111.65

(2) Shelf RAS Polymer Lazy Susan w/ 26"-32" (660-813 mm) Telescoping Post

6072-16-**-52	(2) Shelf Set	16" (406 mm) Diameter	Polymer	\$151.55
6072-18-**-52	(2) Shelf Set	18" (457 mm) Diameter	Polymer	\$153.70
6072-20-**-52	(2) Shelf Set	20" (508 mm) Diameter	Polymer	\$169.65
6072-24-**-52	(2) Shelf Set	24" (610 mm) Diameter	Polymer	\$204.45
6072-28-**-52	(2) Shelf Set	28" (711 mm) Diameter	Polymer	\$218.95
6072-32-**-52	(2) Shelf Set	32" (813 mm) Diameter	Polymer	\$230.55

(3) Shelf RAS Polymer Lazy Susan w/ 38"-46" (965-1169 mm) Telescoping Post

6073-18-**-536	(3) Shelf Set	18" (457 mm) Diameter	Polymer	\$230.55
6073-20-**-536	(3) Shelf Set	20" (508 mm) Diameter	Polymer	\$236.35

NOTES: 1" (26 mm) diameter post system. **6072** - Telescoping post dimensions 9-1/4" (235 mm) upper & 21" (534 mm) lower post **6073** - Telescoping post dimensions 9-1/4" (235 mm) upper & 36" (915 mm) lower post. Additional shelves and/or longer posts can be special ordered. Positioning base without wheels 6260-77-2 mounts on base of cabinet.

PIE-CUT SHELF



(Attaches to the cabinet door)

(2) Shelf RAS Polymer Lazy Susan w/ 26"-32" (660-813 mm) Telescoping Post

PRODUCT	DESCRIPTION	DIMS	FINISH	SLP
6942-24-**-52	(2) Shelf Set	24" (610 mm) Diameter	Polymer	\$136.00
6942-28-**-52	(2) Shelf Set	28" (711 mm) Diameter	Polymer	\$156.60

HALF-MOON SHELF

(2) Shelf RAS Polymer Lazy Susan w/ Pivot

PRODUCT	DESCRIPTION	DIMS	MCO	CAB	FINISH	SLP
6842-31-**-570	(2) Shelf Set	31" (787 mm) Diameter	13-1/4" (337 mm) - FF 15" (381 mm) - FL	BC42	Polymer	\$227.65
6842-33-**-570	(2) Shelf Set	33" (838 mm) Diameter	16-1/8" (410 mm) - FF 17-7/16" (443 mm) - FL	BC45	Polymer	\$233.45
6842-39-**-570	(2) Shelf Set	39" (991 mm) Diameter	19-1/4" (489 mm) - FF 20-3/4" (527 mm) - FL	BC48	Polymer	\$271.15

RAS Polymer Lazy Susan w/ Pivot and Slide

6881-31-**-52	Single Shelf	31" (787 mm) Diameter	13-1/4" (337 mm) - FF 15" (381 mm) - FL	BC42	Polymer	\$187.05
6881-33-**-52	Single Shelf	33" (838 mm) Diameter	16-1/8" (410 mm) - FF 17-7/16" (443 mm) - FL	BC45	Polymer	\$188.50
6881-39-**-52	Single Shelf	39" (991 mm) Diameter	19-1/4" (489 mm) - FF 20-3/4" (527 mm) - FL	BC48	Polymer	\$207.35

(2) Shelf RAS Polymer Lazy Susan w/ Pivot and Slides

6882-31-**-570	(2) Shelf Set	31" (787 mm) Diameter	13-1/4" (337 mm) - FF 15" (381 mm) - FL	BC42	Polymer	\$319.00
6882-33-**-570	(2) Shelf Set	33" (838 mm) Diameter	16-1/8" (410 mm) - FF 17-7/16" (443 mm) - FL	BC45	Polymer	\$324.80
6882-39-**-570	(2) Shelf Set	39" (991 mm) Diameter	19-1/4" (489 mm) - FF 20-3/4" (527 mm) - FL	BC48	Polymer	\$366.85

Hardware

6882-1008-04-52	Half-Moon Slide Kit (1 Pair)	10-1/2" (267 mm) Extension			Polymer	\$66.25
-----------------	------------------------------	----------------------------	--	--	---------	---------

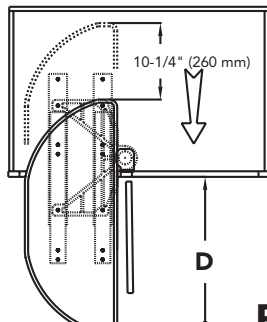
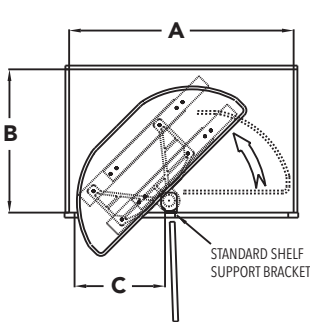

FRAMED CABINET

DIMENSIONS A, B, AND C ARE MINIMUMS. 31" TRAY SHOWN IN DIAGRAM.

NOM Tray size	A	B	C	D
31" (787 mm)	33-11/16" (856 mm)	21-1/2" (546 mm)	13-1/4" (344 mm)	21-1/16" (535 mm)
33" (838 mm)	34-5/16" (872 mm)	18-9/16" (471 mm)	16-1/8" (410 mm)	24-1/16" (611 mm)
39" (991 mm)	40-11/16" (1033 mm)	21-13/16" (554 mm)	19-1/4" (491 mm)	27-3/8" (695 mm)

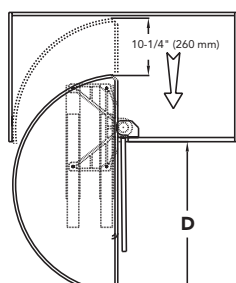
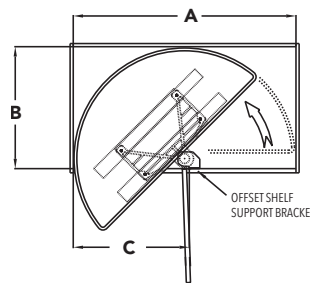

FRAMELESS CABINET

DIMENSIONS A, B, AND C ARE MINIMUMS. 39" TRAY SHOWN IN DIAGRAM.

NOM Tray size	A	B	C	D
31" (787 mm)	32-13/16" (833 mm)	21-1/2" (546 mm)	15" (381 mm)	21-1/16" (535 mm)
33" (838 mm)	33-3/16" (843 mm)	18-9/16" (471 mm)	17-7/16" (443 mm)	24-1/16" (611 mm)
39" (991 mm)	39-7/8" (1013 mm)	21-13/16" (554 mm)	20-3/4" (527 mm)	27-3/8" (695 mm)

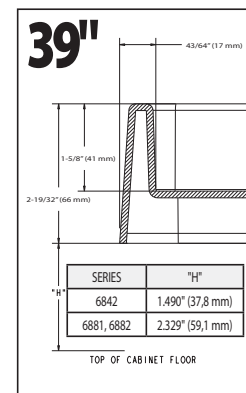
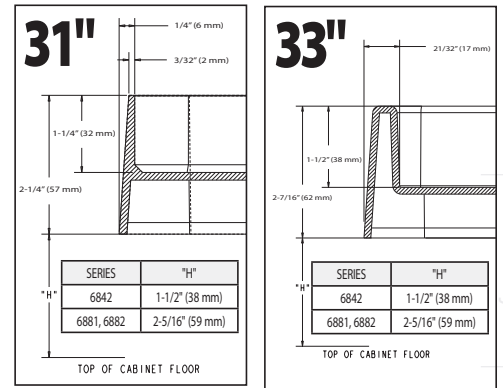

SPECIFICATIONS

POLYMER SHELVES

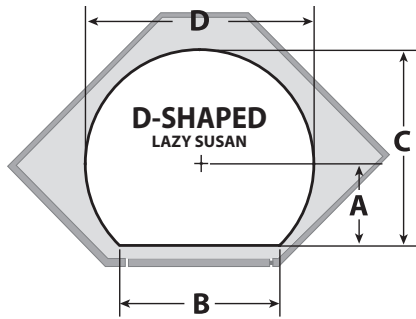

Shelf	Material	Series	A	B	C	D	Post System
20" D-Shaped	Polymer	6200	8-7/8"	9-1/4"	19"	20-1/8"	1" IND.
22" D-Shaped	Polymer	6200	7-3/16"	16-5/8"	18-3/16"	22"	1" IND.

Ind. = Independently Rotating System

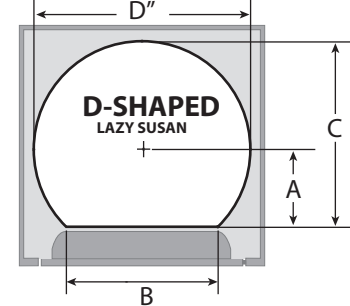

Shelf	Material	Series	A	B	C	D	Post System
20" D-Shaped	Polymer	7000	8-7/8"	9-1/4"	18-7/8"	20"	3/4" DEP.

DEP. = Dependently Rotating System

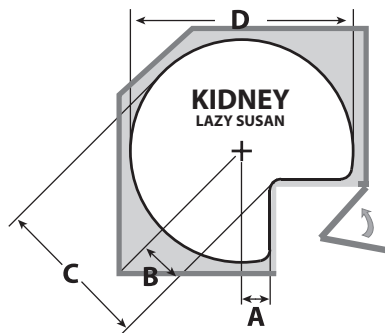

Shelf	Material	Series	A	B	C	D	Post System
18" Kidney	Polymer	6471	1-3/4"	2-13/16"	11-13/16"	18"	1" IND.
24" Kidney	Polymer	6471	1-1/2"	2-5/16"	14-5/16"	24"	1" IND.
28" Kidney	Polymer	6471	3"	4-11/16"	18-5/8"	28"	1" IND.
32" Kidney	Polymer	6471	4-1/4"	6-7/16"	22-7/16"	32"	1" IND.

IND. = Independently Rotating System

Shelf	Material	Series	A	B	C	D	Z	Post System
24" Pie-Cut	Polymer	6942	1-3/8"	1-15/16"	13-15/16"	24"	10-9/16" + 1/8" gap	1" DEP.
28" Pie-Cut	Polymer	6942	3"	4-1/4"	18-1/4"	28"	11" + 1/8" gap	1" DEP.

DEP. = Dependently Rotating System

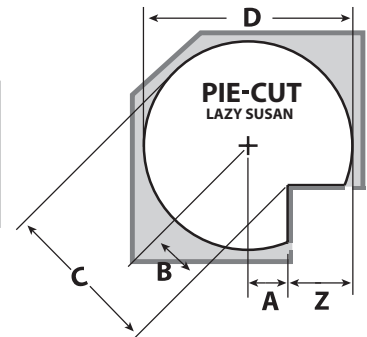

For custom applications, a trial installation is recommended.
Door edge profile, thickness and gaps all factor in installation

LIP SPECIFICATIONS

PIE-CUT POLYMER SHELVES

Dimensions are for reference only, and may change based on hardware used, etc.

1" Shaft Pie-Cut	"H"
6942-24	1/4" (6 mm) *
6942-28	1/4" (6 mm) *

*6942-24 and 6942-28 can sit flush on top of the cabinet floor. 1/4" (6 mm) is recommended for clearance.

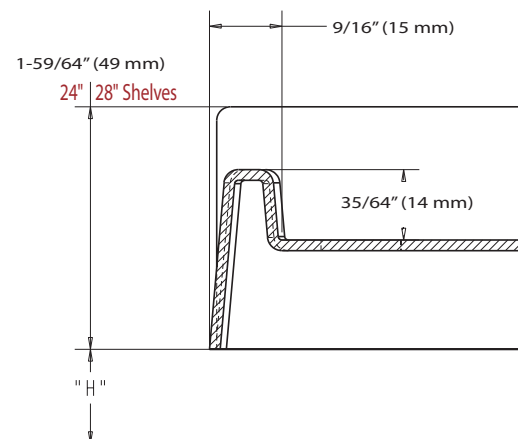

REV-A-SHELF® LAZY SUSANS ARE TESTED TO EXCEED BHMA CLASS 1 SPECIFICATIONS

TOP OF CABINET FLOOR

Dimensions are for reference only, and may change based on hardware used, etc.

WALL SHELVES

Polymer Lazy Susan

Full-Circle	"H"
3072-18	5/16" (8 mm)
6621-16, 18 & 20	1-19/64" (33 mm)
6072-16, 18 & 20	1-19/64" (33 mm)
6073-18 & 20	1-19/64" (33 mm)
6065-16 & 18	2-9/32" (58 mm)
6012-18 & 20	1/4" (6 mm)*
6013-18 & 20	1/4" (6 mm)*
Kidney	"H"
6421-18	1-19/64" (33 mm)
6472-18	1-19/64" (33 mm)

BASE SHELVES

Polymer Lazy Susan

Full-Circle	"H"
3072-24 & 28	1-3/64" (27 mm)
6621-24, 28 & 32	1-15/64" (31 mm)
6072-24, 28 & 32	1-15/64" (31 mm)
Kidney	"H"
3472-24, 28 & 32	1-3/64" (27 mm)
6421-24, 28 & 32	1-15/64" (31 mm)
6472-24, 28 & 32	1-15/64" (31 mm)

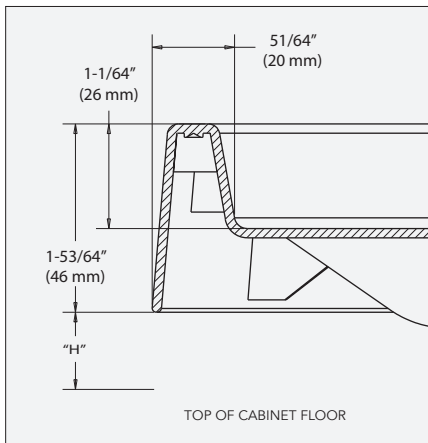

WALL SHELVES

Independently Rotation

20" D-Shaped	"H"
6221-20	1-1/2" (38 mm)
6272-20	1-1/2" (38 mm)
6273-20	1-1/2" (38 mm)
Dependently Rotation	"H"
20" D-Shaped	"H"
7012-20	1/4" (6 mm)
7013-20	1/4" (6 mm)

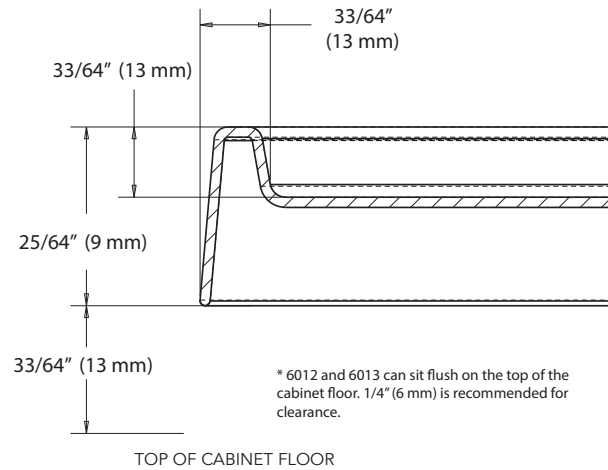

PANTRY SHELVES

Polymer Lazy Susan

22" D-Shaped	"H"
6221-22	1-15/64" (31 mm)
6272-22	1-15/64" (31 mm)
6273-22	1-15/64" (31 mm)
6265-22	2-13/64" (56 mm)

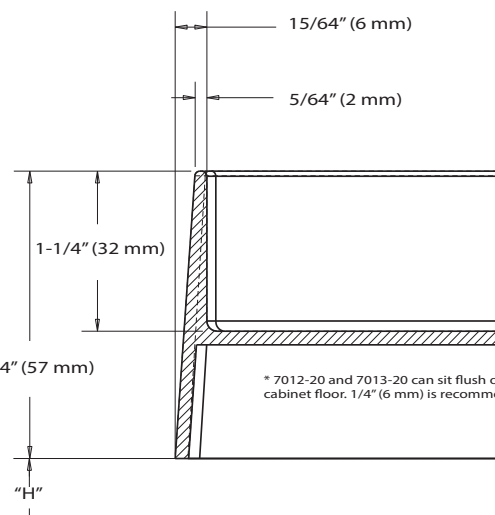
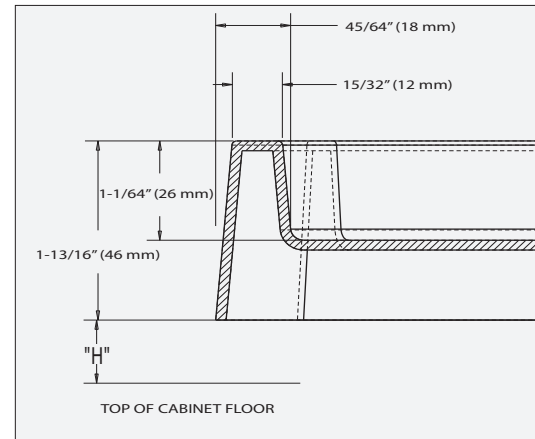

Lazy Susan

Banded Wood

- 2" banded wood rim
- Doweled (2) butt joint
- 5/8" thick maple shelf bottom
- Independently rotating
- Almond hardware
- Steel bearings

All wood products are TSCA Title VI compliant

Our Lazy Susans are tested to exceed
BHMA Class 1 Specs: 20 lbs. per square
foot at 75K cycles.

All of our lazy susans are manufactured using
high quality materials and are backed by a
limited Lifetime Warranty. We have devel-
oped a tiered category system (Good, Better,
Best) that will allow you to quickly identify
which configuration will give you the features
you want, with the value you require.



Good



Tray Configurations

Call for Bulk Pricing 800-626-1126

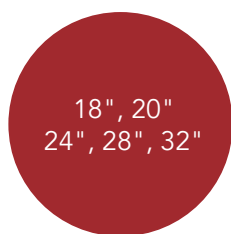

18", 20"
24", 28", 32"

Full-Circle

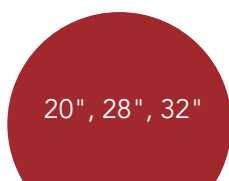

20", 28", 32"

D-Shaped

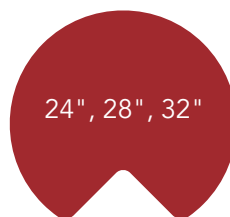

24", 28", 32"

Kidney-Shaped

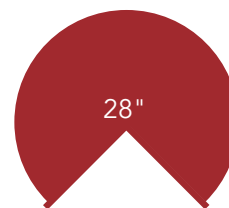

28"

Pie-Cut

See Page 323 for Hardware

FULL-CIRCLE SHELF



Banded Wood Lazy Daisy w/ Steel Bearing

PRODUCT	DESCRIPTION	DIMS	FINISH	SLP
LD-4BW-001-18SB-1	Single Shelf w/ 7" Steel Bearing	18" (457 mm) Diameter	Maple	\$120.35
LD-4BW-001-20SB-1	Single Shelf w/ 7" Steel Bearing	20" (508 mm) Diameter	Maple	\$123.25
LD-4BW-001-24SB-1	Single Shelf w/ 10" Steel Bearing	24" (610 mm) Diameter	Maple	\$155.15
LD-4BW-001-28SB-1	Single Shelf w/ 10" Steel Bearing	28" (711 mm) Diameter	Maple	\$175.45
LD-4BW-001-32SB-1	Single Shelf w/ 10" Steel Bearing	32" (813 mm) Diameter	Maple	\$210.25

(2) Shelf Banded Wood Lazy Daisy w/ 26"-31" (660-788 mm) Telescoping Post

LD-4BW-062-18-1	(2) Shelf Set	18" (457 mm) Diameter	Maple	\$230.55
LD-4BW-062-20-1	(2) Shelf Set	20" (508 mm) Diameter	Maple	\$232.75
LD-4BW-062-24-1	(2) Shelf Set	24" (610 mm) Diameter	Maple	\$276.20
LD-4BW-062-28-1	(2) Shelf Set	28" (711 mm) Diameter	Maple	\$321.90
LD-4BW-062-32-1	(2) Shelf Set	32" (813 mm) Diameter	Maple	\$382.80

(3) Shelf Banded Wood Lazy Daisy w/ 38"-46" (965-1169 mm) Telescoping Post

LD-4BW-063-1836-1	(3) Shelf Set	18" (457 mm) Diameter	Maple	\$350.90
LD-4BW-063-2036-1	(3) Shelf Set	20" (508 mm) Diameter	Maple	\$355.25

*Note: Non-drilled trays without bearings are available, remove "SB" from product number.

PIE-CUT SHELF



(Attaches to the cabinet door)

(2) Shelf Banded Wood Lazy Daisy w/ Hardware

PRODUCT	DESCRIPTION	DIMS	FINISH	SLP
LD-4BW-942-28-1	(2) Shelf Set	28" (711 mm) Diameter	Maple	\$342.20

KIDNEY-SHAPED SHELF



(Hinged door; not attached)

Banded Wood Lazy Daisy w/ Steel Bearing and Stop

PRODUCT	DESCRIPTION	DIMS	FINISH	SLP
LD-4BW-401-28SBS-1	Single Shelf w/ 7" Steel Bearing	28" (711 mm) Diameter	Maple	\$155.15
LD-4BW-401-32SBS-1	Single Shelf w/ 10" Steel Bearing	32" (813 mm) Diameter	Maple	\$194.30

(2) Shelf Banded Wood Lazy Daisy w/ 26"-31" (660-788 mm) Telescoping Post

LD-4BW-472-24-1	(2) Shelf Set	24" (610 mm) Diameter	Maple	\$266.05
LD-4BW-472-28-1	(2) Shelf Set	28" (711 mm) Diameter	Maple	\$294.35
LD-4BW-472-32-1	(2) Shelf Set	32" (813 mm) Diameter	Maple	\$344.40

*Note: Non-drilled trays without bearings are available, remove "SBS" from product number.

D-SHAPED SHELF



Banded Wood Lazy Daisy w/ Steel Bearing

PRODUCT	DESCRIPTION	DIMS	FINISH	SLP
LD-4BW-201-20SBS-1	Single Shelf w/ 7" Steel Bearing	20" (508 mm) Diameter	Maple	\$126.15
LD-4BW-201-28SBS-1	Single Shelf w/ 7" Steel Bearing	28" (711 mm) Diameter	Maple	\$178.35
LD-4BW-201-32SBS-1	Single Shelf w/ 10" Steel Bearing	32" (813 mm) Diameter	Maple	\$211.00

(2) Shelf Banded Wood Lazy Daisy w/ 26"-31" (660-788 mm) Telescoping Post

LD-4BW-262-20-1	(2) Shelf Set	20" (508 mm) Diameter	Maple	\$216.05
LD-4BW-262-28-1	(2) Shelf Set	28" (711 mm) Diameter	Maple	\$303.05
LD-4BW-262-32-1	(2) Shelf Set	32" (813 mm) Diameter	Maple	\$358.15

(3) Shelf Banded Wood Lazy Daisy w/ 38"-46" (965-1169 mm) Telescoping Post

LD-4BW-263-2036-1	(3) Shelf Set	20" (508 mm) Diameter	Maple	\$318.15
-------------------	---------------	-----------------------	-------	----------

*Note: Non-drilled trays without bearings are available, remove "SBS" from product number.

SPECIFICATIONS

BANDED WOOD SHELVES

Shelf	Material	Series	A	B	C	D	Post System
20" D-Shaped	Maple	LD-4BW	8-7/8"	6-7/8"	18-1/2"	19-1/2"	1" IND.
28" D-Shaped	Maple	LD-4BW	11-5/8"	13-1/4"	25-1/2"	27-3/4"	1" IND.
32" D-Shaped	Maple	LD-4BW	13-7/8"	13-7/8"	29-3/4"	31-3/4"	1" IND.

IND. = Independently Rotating System

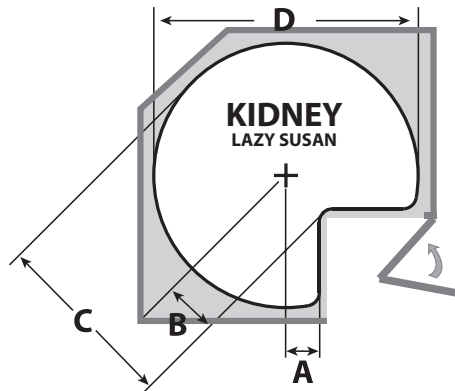
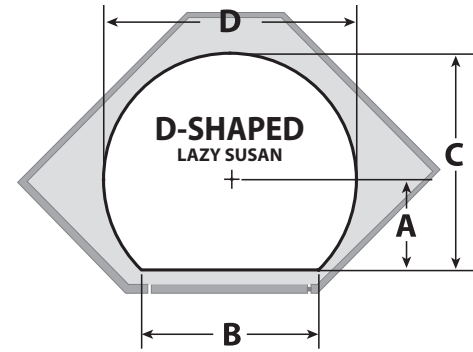

Shelf	Material	Series	A	B	C	D	Post System
24" Kidney	Maple	LD-4BW	1-1/2"	2-3/8"	14-3/8"	24"	1" IND.
28" Kidney	Maple	LD-4BW	2-7/8"	4-3/8"	18-1/4"	27-3/4"	1" IND.
32" Kidney	Maple	LD-4BW	4"	6"	21-7/8"	31-3/4"	1" IND.

IND. = Independently Rotating System

For custom applications a trial installation is recommended.
Door edge profile, thickness, and gaps all factor in installation.

Shelf	Material	Series	A	B	C	D	Z	Post System
28" Pie-Cut	Maple	LD-4BW	3"	4-1/4"	18-1/8"	27-3/4"	10-7/8" + 1/8" gap	1" DEP.

DEP. = Dependently Rotating System

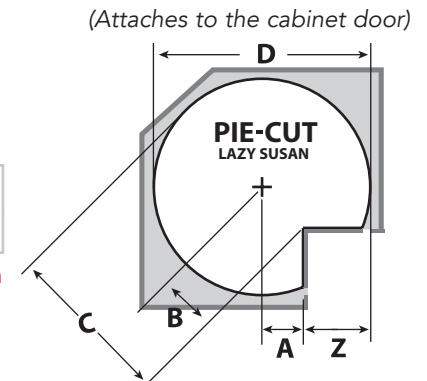

(Attaches to the cabinet door)

LIP SPECIFICATIONS

BANDED WOOD SHELVES

Hardware	Tray Shape	"H"
Steel Bearing	FC, Kidney and D-Shaped	7/8" (23 mm)
Telescopic Post	Full Circle	1-13/32" (36 mm)
Telescopic Post	Kidney and D-Shaped	1-11/64" (30 mm)
Telescopic Post	Pie Cut	1-57/64" (48 mm)

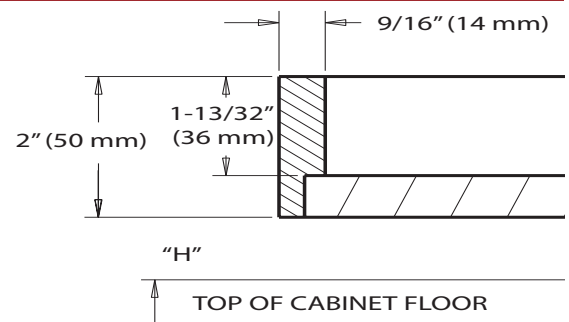



- 1-5/8" solid wood frame
- Finger joint
- 5/8" thick natural maple shelf bottom
- Chrome hardware
- Aluminum bearings

All wood products are TSCA Title VI compliant

Our Lazy Susans are tested to exceed BHMA Class 1 Specs: 20 lbs. per square foot at 75K cycles.

All of our lazy susans are manufactured using high quality materials and are backed by a limited Lifetime Warranty. We have developed a tiered category system (Good, Better, Best) that will allow you to quickly identify which configuration will give you the features you want, with the value you require.



Better



Tray Configurations

Call for Bulk Pricing 800-626-1126

10", 18", 20", 22",
28", 32"

Full-Circle

20", 22", 31"

D-Shaped

24", 28", 32"

Kidney-Shaped

24", 28", 31"

Pie-Cut

32", 35", 38"

Half-Moon

FULL-CIRCLE SHELF



Wood Classic Lazy Susan - No Hardware

PRODUCT	DESCRIPTION	DIMS	FINISH	SLP
4WLS001-18-52	Single Shelf	18" (457 mm) Diameter	Wood	\$106.60
4WLS001-20-52	Single Shelf	20" (508 mm) Diameter	Wood	\$121.80
4WLS001-28-52	Single Shelf	28" (711 mm) Diameter	Wood	\$166.75
4WLS001-32-52	Single Shelf	32" (813 mm) Diameter	Wood	\$195.75

Wood Classic Lazy Susan w/ Aluminum Bearing

4WLS001-10-B52	Single Shelf w/ 7" Aluminum Bearing	10" (254 mm) Diameter	Wood	\$129.05
4WLS001-18-B52	Single Shelf w/ 7" Aluminum Bearing	18" (457 mm) Diameter	Wood	\$147.90
4WLS001-20-B52	Single Shelf w/ 7" Aluminum Bearing	20" (508 mm) Diameter	Wood	\$164.55
4WLS001-28-B52	Single Shelf w/ 10" Aluminum Bearing	28" (711 mm) Diameter	Wood	\$232.00
4WLS001-32-B52	Single Shelf w/ 10" Aluminum Bearing	32" (813 mm) Diameter	Wood	\$245.05

(2) Shelf Wood Classic Lazy Susan w/ 26"-32" (660-813 mm) Telescoping Post

4WLS072-18-52	(2) Shelf Set	18" (457 mm) Diameter	Wood	\$271.15
4WLS072-20-52	(2) Shelf Set	20" (508 mm) Diameter	Wood	\$285.65
4WLS072-22-52	(2) Shelf Set	22" (559 mm) Diameter	Wood	\$332.05
4WLS072-28-52	(2) Shelf Set	28" (711 mm) Diameter	Wood	\$420.50
4WLS072-32-52	(2) Shelf Set	32" (813 mm) Diameter	Wood	\$442.25

(3) Shelf Wood Classic Lazy Susan w/ 38"-46" (965-1169 mm) Telescoping Post

4WLS073-18-536	(3) Shelf Set	18" (457 mm) Diameter	Wood	\$382.80
4WLS073-20-536	(3) Shelf Set	20" (508 mm) Diameter	Wood	\$435.00

NOTE: 4WLS073-536 denotes telescoping post 9-1/4" (235 mm) upper & 36" (915 mm) lower assembly for 38"-46" (889-1092 mm) inner cabinet height wall cabinets, (3) shelves, top & bottom pivots & fasteners. Positioning base without wheels 6260-77-2 mounts on base of cabinet.

D-SHAPED SHELF



Wood Classic Lazy Susan - No Hardware

PRODUCT	DESCRIPTION	DIMS	FINISH	SLP
4WLS201-20-52	Single Shelf	20" (508 mm) Diameter	Wood	\$127.60
4WLS201-31-52	Single Shelf	31" (787 mm) Diameter	Wood	\$189.95

Wood Classic Lazy Susan w/ Aluminum Bearing

4WLS201-20-B552	Single Shelf w/ 7" Aluminum Bearing	20" (508 mm) Diameter	Wood	\$189.95
4WLS201-22-B552	Single Shelf w/ 7" Aluminum Bearing	22" (559 mm) Diameter	Wood	\$201.55
4WLS201-31-B552	Single Shelf w/ 10" Aluminum Bearing	31" (787 mm) Diameter	Wood	\$239.25

(2) Shelf Wood Classic Lazy Susan w/ 26"-32" (660-813 mm) Telescoping Post

4WLS272-20-52	(2) Shelf Set	20" (508 mm) Diameter	Wood	\$319.00
4WLS272-22-52	(2) Shelf Set	22" (559 mm) Diameter	Wood	\$339.30
4WLS272-31-52	(2) Shelf Set	31" (787 mm) Diameter	Wood	\$459.65

(3) Shelf Wood Classic Lazy Susan w/ 38"-46" (965-1169 mm) Telescoping Post

4WLS273-20-536	(3) Shelf Set	20" (508 mm) Diameter	Wood	\$471.25
----------------	---------------	-----------------------	------	----------

KIDNEY-SHAPED SHELF



(Hinged door; not attached)

Wood Classic Lazy Susan - No Hardware

PRODUCT	DESCRIPTION	DIMS	FINISH	SLP
4WLS401-24-52	Single Shelf	24" (610 mm) Diameter	Wood	\$184.15
4WLS401-28-52	Single Shelf	28" (711 mm) Diameter	Wood	\$192.85
4WLS401-32-52	Single Shelf	32" (813 mm) Diameter	Wood	\$206.65

Wood Classic Lazy Susan w/ Aluminum Bearing

4WLS401-28-BS52	Single Shelf w/ 7" Aluminum Bearing	28" (711 mm) Diameter	Wood	\$239.25
4WLS401-32-BS52	Single Shelf w/ 10" Aluminum Bearing	32" (813 mm) Diameter	Wood	\$262.45

(2) Shelf Wood Classic Lazy Susan w/ 26"-32" (660-813 mm) Telescoping Post

4WLS472-24-52	(2) Shelf Set	24" (610 mm) Diameter	Wood	\$382.20
4WLS472-28-52	(2) Shelf Set	28" (711 mm) Diameter	Wood	\$393.70
4WLS472-32-52	(2) Shelf Set	32" (813 mm) Diameter	Wood	\$475.15

NOTE: Positioning base with wheels 6260-95-2 mounts on base of cabinet. 24" Kidney is too small for swivel bearing w/stop hardware, therefore you must use post & pivot hardware. Bulk shelves (4WLS041) and hardware sold separately. Telescoping post assembly accommodates 26"-32" (660-813 mm) inner cabinet height, 1" (26 mm) diameter post system.

PIE-CUT SHELVES



(Attaches to the cabinet door)

Wood Classic Lazy Susan - No Hardware

PRODUCT	DESCRIPTION	DIMS	FINISH	SLP
4WLS901-24-52	Single Shelf Drilled	24" (610 mm) Diameter	Wood	\$184.15
4WLS901-28-52	Single Shelf Drilled	28" (711 mm) Diameter	Wood	\$192.85
4WLS901-31-52	Single Shelf Drilled	31" (788 mm) Diameter	Wood	\$221.85

(2) Shelf Wood Classic Lazy Susan w/ 26"-32" (660-813 mm) Telescoping Post

4WLS942-2433-52	(2) Shelf Set for 33" Corner	24" (607 mm) Diameter	Wood	\$391.50
4WLS942-24P-52	(2) Shelf Set	24" (607 mm) Diameter	Wood	\$391.50
4WLS942-28P-52	(2) Shelf Set	28" (711 mm) Diameter	Wood	\$406.00
4WLS942-31P-52	(2) Shelf Set	31" (788 mm) Diameter	Wood	\$461.10

NOTES: Upper shelf is adjustable, lower shelf is in fixed position and post cannot be altered (adjustment mechanism).

HALF-MOON SHELVES



(2) Shelf Wood Classic Half-Moon Lazy Susans w/ Pivot and Slide

PRODUCT	DESCRIPTION	DIMS	MCO	CAB	FINISH	SLP
4WLS882-32-570	(2) Shelf Set	32-1/4" (819 mm) W x 11-13/32" (290 mm) D x 15-15/16" (405 mm) H	12" (305 mm) - FF 13-1/4" (337 mm) - FL	BC42	Maple	\$442.25
4WLS882-35-570	(2) Shelf Set	35" (889 mm) W x 14-13/32" (366 mm) D x 15-15/16" (405 mm) H	15" (381 mm) - FF 16-1/4" (413 mm) - FL	BC45	Maple	\$517.65
4WLS882-38-570	(2) Shelf Set	37-3/4" (959 mm) W x 17-11/32" (443 mm) D x 15-15/16" (405 mm) H	18" (457 mm) - FF 19-1/4" (489 mm) - FL	BC48	Maple	\$596.10

LIP SPECIFICATIONS

WOOD CLASSIC SHELVES

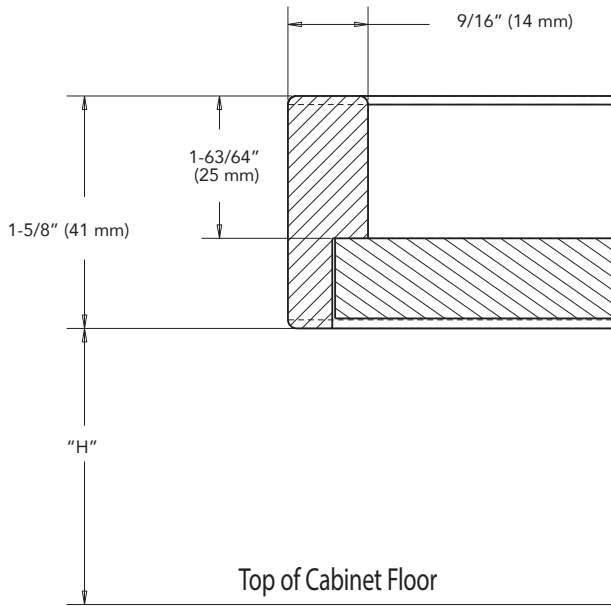

Wood Lazy Susan	
Full-Circle	"H"
4WLS001	3/4" (19 mm)
4WLS072	1-19/64" (33 mm)
4WLS073	1-19/64" (33 mm)
D-Shaped	"H"
4WLS221	1-19/64" (33 mm)
4WLS201	3/4" (19 mm)
4WLS272	1-19/64" (33 mm)
4WLS273	1-19/64" (33 mm)
Pie-Cut	"H"
4WLS942	1-29/64" (37 mm)
Kidney	"H"
4WLS401	3/4" (19 mm)
4WLS472	1-19/64" (33 mm)
Half-Moon	"H"
4WLS882	2-33/64" (64 mm)

Dimensions are for reference only, and may change based on hardware used, etc.

SPECIFICATIONS

WOOD CLASSIC SHELVES

(Attaches to the cabinet door)

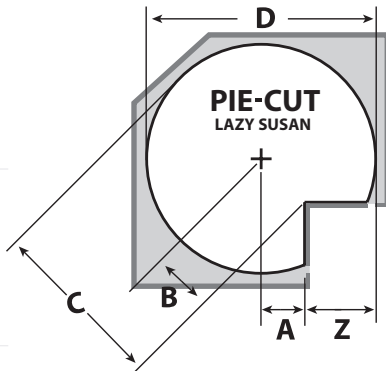

Shelf	Material	Series	A	B	C	D	Z	Post System
2433 Pie-Cut	Wood	4WLS	4-9/16"	6-7/16"	18-7/16"	24"	7-7/16" + 1/8" gap	1" DEP.
24" Pie-Cut	Wood	4WLS	1-3/8"	1-15/16"	13-15/16"	24"	10-9/16" + 1/8" gap	1" DEP.
28" Pie-Cut	Wood	4WLS	3"	4-1/4"	18-1/8"	28"	10-7/8" + 1/8" gap	1" DEP.
31" Pie-Cut	Wood	4WLS	5-1/16"	7-1/8"	22-7/16"	31"	10-5/16" + 1/8" gap	1" DEP.

DEP. = Dependently Rotating System

For custom applications, a trial installation is recommended.
Door edge profile, thickness and gaps all factor in installation.

Shelf	Material	Series	A	B	C	D	Post System
20" D-Shaped	Wood	4WLS	8-3/8"	10-5/8"	18-3/8"	20"	1" IND.
22" D-Shaped	Wood	4WLS	7-3/16"	16-5/8"	18-3/16"	22"	1" IND.
31" D-Shaped	Wood	4WLS	14"	13"	29-3/8"	31"	1" IND.

IND. = Independently Rotating System

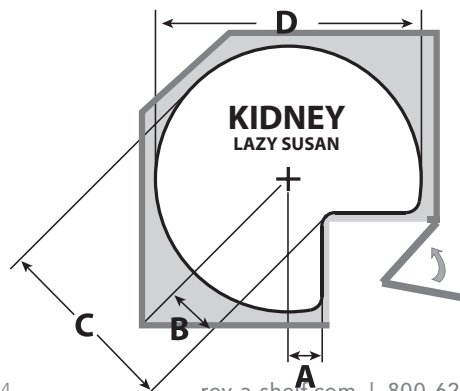
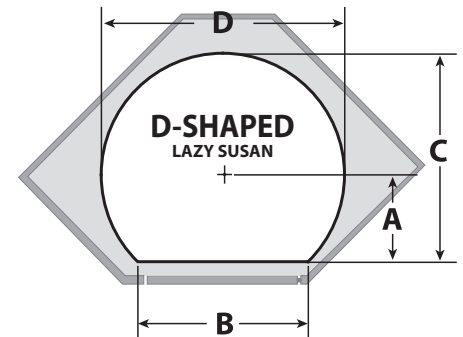

Shelf	Material	Series	A	B	C	D	Post System
24" Kidney	Wood	4WLS	1-7/16"	2-3/8"	14-3/8"	23-15/16"	1" IND.
28" Kidney	Wood	4WLS	2-7/8"	4-3/8"	18-1/4"	27-3/4"	1" IND.
32" Kidney	Wood	4WLS	4-1/16"	6"	21-15/16"	31-3/4"	1" IND.

IND. = Independently Rotating System

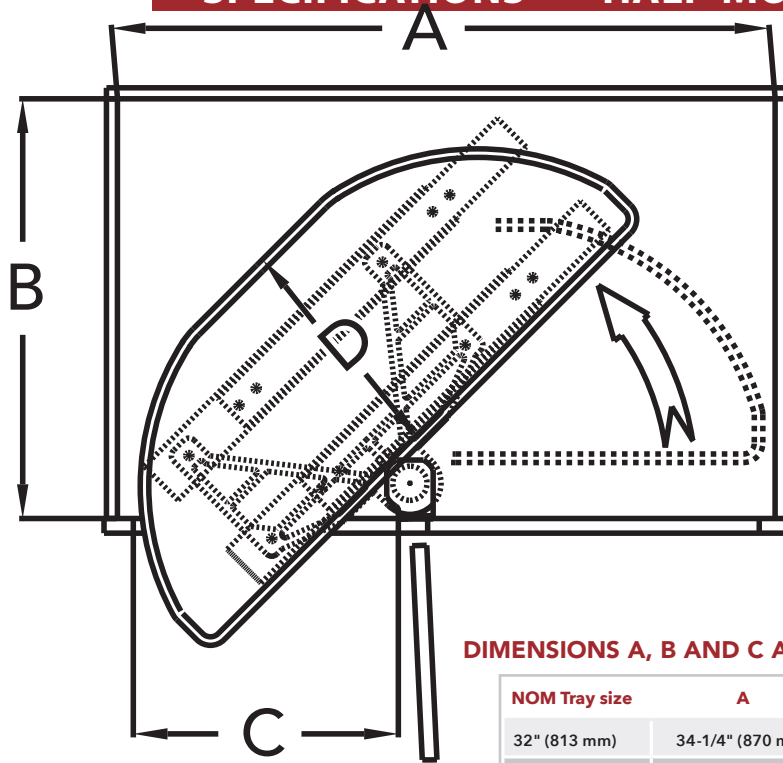
**FRAMED CABINET**

DIMENSIONS A, B AND C ARE MINIMUMS. 32" TRAY SHOWN IN DIAGRAM.

NOM Tray size	A	B	C	D
32" (813 mm)	34-1/4" (870 mm)	22-5/8" (575 mm)	12" (305 mm)	11-1/8" (283 mm)
35" (889 mm)	37" (940 mm)	22" (559 mm)	15" (381 mm)	14-1/8" (359 mm)
38" (965 mm)	39-1/2" (1003 mm)	22" (559 mm)	18" (457 mm)	17-1/8" (435 mm)

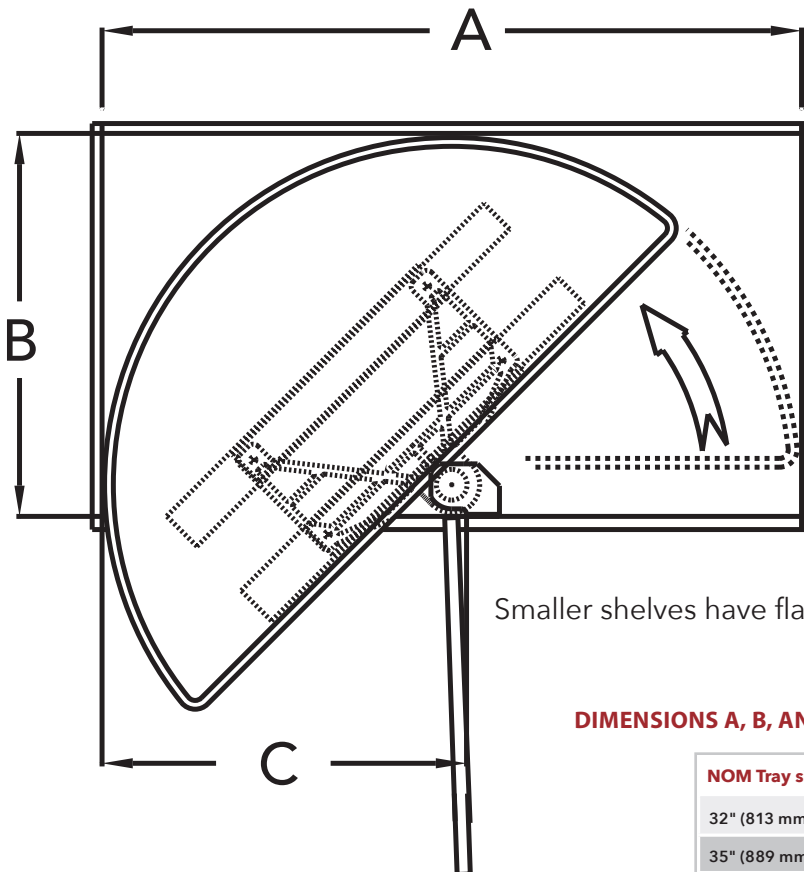

Smaller shelves have flat backs.

FRAMELESS CABINET

DIMENSIONS A, B, AND C ARE MINIMUMS. 38" TRAY SHOWN IN DIAGRAM.

NOM Tray size	A	B	C
32" (813 mm)	34-1/8" (867 mm)	22-5/8" (575 mm)	13-1/4" (337 mm)
35" (889 mm)	35-3/16" (897 mm)	22" (559 mm)	16-1/4" (413 mm)
38" (965 mm)	38-9/16" (980 mm)	22" (559 mm)	19-1/4" (489 mm)

Lazy Susan

Natural Wood

- 2-3/8" steam bent rim (3-1/4" for tall)
- 5/8" thick natural maple shelf bottom
- Chrome hardware
- Doweled (2) butt joint
- Aluminum bearings

All wood products are TSCA Title VI compliant

Our Lazy Susans are tested to exceed BHMA Class 1 Specs: 20 lbs. per square foot at 75K cycles.

All of our lazy susans are manufactured using high quality materials and are backed by a limited Lifetime Warranty. We have developed a tiered category system (Good, Better, Best) that will allow you to quickly identify which configuration will give you the features you want, with the value you require.



Best



Shelf Configurations

Call for Bulk Pricing 800-626-1126

18", 24", 28", 32"

Full-Circle

20", 28", 32"
(Available in Tall- except 28")

D-Shaped

18", 28", 32"
(Available in Tall- except 18")

Kidney-Shaped

28"

Pie-Cut

32", 35", 38"

Half-Moon

See Page 323 for Hardware

FULL-CIRCLE SHELF

Natural Wood Lazy Daisy w/ Aluminum Bearing

PRODUCT	DESCRIPTION	DIMS	FINISH	SLP
LD-4NW-001-18B-1	Single Shelf w/ 7" Aluminum Bearing	18" (457 mm) Diameter	Wood	\$143.55
LD-4NW-001-24B-1	Single Shelf w/ 10" Aluminum Bearing	24" (610 mm) Diameter	Wood	\$207.35
LD-4NW-001-28B-1	Single Shelf w/ 10" Aluminum Bearing	28" (711 mm) Diameter	Wood	\$231.30
LD-4NW-001-32B-1	Single Shelf w/ 10" Aluminum Bearing	32" (813 mm) Diameter	Wood	\$274.05

(2) Shelf Natural Wood Lazy Daisy w/ 26"-32" (660-813 mm) Telescoping Post

LD-4NW-072-18-1	(2) Shelf Set	18" (457 mm) Diameter	Wood	\$250.85
LD-4NW-072-24-1	(2) Shelf Set	24" (610 mm) Diameter	Wood	\$340.75
LD-4NW-072-28-1	(2) Shelf Set	28" (711 mm) Diameter	Wood	\$398.75
LD-4NW-072-32-1	(2) Shelf Set	32" (813 mm) Diameter	Wood	\$450.95

(3) Shelf Natural Wood Lazy Daisy w/ 38"-46" (965-1169 mm) Telescoping Post

LD-4NW-073-1836-1	(3) Shelf Set	18" (457 mm) Diameter	Wood	\$359.60
-------------------	---------------	-----------------------	------	----------

*Note: Non-drilled trays without bearings are available, remove "B" from product number.

(Attaches to the cabinet door)

PIE-CUT SHELF

(2) Shelf Natural Wood Lazy Daisy w/ 26"-32" (660-813 mm) Telescoping Post

PRODUCT	DESCRIPTION	DIMS	FINISH	SLP
LD-4NW-942-28-1	(2) Shelf Set	28" (711 mm) Diameter	Wood	\$459.65

D-SHAPED SHELF

Natural Wood Lazy Daisy w/ Aluminum Bearing and Stop

PRODUCT	DESCRIPTION	DIMS	FINISH	SLP
LD-4NW-201-20BS-1	Single Shelf w/ 7" Aluminum Bearing	20" (508 mm) Diameter	Wood	\$187.05
LD-4NW-201-28BS-1	Single Shelf w/ 10" Aluminum Bearing	28" (711 mm) Diameter	Wood	\$237.95
LD-4NW-201-32BS-1	Single Shelf w/ 10" Aluminum Bearing	32" (813 mm) Diameter	Wood	\$274.05

Tall Natural Wood Lazy Daisy w/ Aluminum Bearing and Stop

LD-4NW-201-20TBS-1	Single Shelf w/ 7" Aluminum Bearing	20" (508 mm) Diameter	Wood	\$201.55
LD-4NW-201-32TBS-1	Single Shelf w/ 10" Aluminum Bearing	32" (813 mm) Diameter	Wood	\$288.55

(2) Shelf Natural Wood Lazy Daisy w/ 26"-32" (660-813 mm) Telescoping Post

LD-4NW-272-20-1	(2) Shelf Set	20" (508 mm) Diameter	Wood	\$307.40
LD-4NW-272-28-1	(2) Shelf Set	28" (711 mm) Diameter	Wood	\$406.00
LD-4NW-272-32-1	(2) Shelf Set	32" (813 mm) Diameter	Wood	\$464.00

HALF-MOON SHELF

Natural Wood Half Moon Lazy Susans

PRODUCT	DESCRIPTION	DIMS	MCO	CAB	FINISH	SLP
LD-4NW-882-32-1	(2) Shelf Set	32-1/8" (817 mm) W x 11-1/8" (283 mm) D x 15-15/16" (405 mm) H	12" (305 mm) - FF 13-1/4" (337 mm) - FL	BC42	Wood	\$493.00
LD-4NW-882-35-1	(2) Shelf Set	34-7/8" (886 mm) W x 14-1/8" (359 mm) D x 15-15/16" (405 mm) H	15" (381 mm) - FF 16-1/4" (413 mm) - FL	BC45	Wood	\$536.50
LD-4NW-882-38-1	(2) Shelf Set	38" (965 mm) W x 17-1/8" (435 mm) D x 15-15/16" (405 mm) H	18" (457 mm) - FF 19-1/4" (489 mm) - FL	BC48	Wood	\$609.00

KIDNEY-SHAPED SHELF



(Hinged door; not attached)

Natural Wood Lazy Daisy w/ Aluminum Bearing and Stop

PRODUCT	DESCRIPTION	DIMS	FINISH	SLP
LD-4NW-401-28BS-1	Single Shelf w/ 7" Aluminum Bearing	28" (711 mm) Diameter	Wood	\$255.20
LD-4NW-401-32BS-1	Single Shelf w/ 10" Aluminum Bearing	32" (813 mm) Diameter	Wood	\$303.05

Tall Natural Wood Lazy Daisy w/ Aluminum Bearing and Stop

LD-4NW-401-28TBS-1	Single Shelf w/ 7" Aluminum Bearing	28" (711 mm) Diameter	Wood	\$264.65
LD-4NW-401-32TBS-1	Single Shelf w/ 10" Aluminum Bearing	32" (813 mm) Diameter	Wood	\$311.75

(2) Shelf Natural Wood Lazy Daisy w/ 26"-32" (660-813 mm) Telescoping Post

LD-4NW-472-18-1	(2) Shelf Set	18" (457 mm) Diameter	Wood	\$286.40
LD-4NW-472-28-1	(2) Shelf Set	28" (711 mm) Diameter	Wood	\$471.25
LD-4NW-472-32-1	(2) Shelf Set	32" (813 mm) Diameter	Wood	\$529.25

*Note: Non-drilled trays without bearings are available, remove "BS" from product number.

SPECIFICATIONS

NATURAL WOOD SHELVES

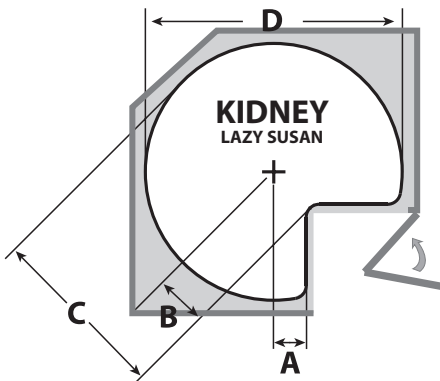

Shelf	Material	Series	A	B	C	D	Post System
18" Kidney	Maple	LD-4NW	1-7/8"	2-9/16"	11-1/2"	18"	1" IND.
24" Kidney	Maple	LD-4NW	1-7/8"	2-1/2"	11-1/2"	24"	1" IND.
28" Kidney	Maple	LD-4NW	3"	4-1/4"	18-1/8"	27-3/4"	1" IND.
32" Kidney	Maple	LD-4NW	4"	5-3/4"	21-5/8"	31-3/4"	1" IND.

IND. = Independently Rotating System

Shelf	Material	Series	A	B	C	D	Z	Post System
28" Pie-Cut	Maple	LD-4NW	3"	4-1/4"	18-1/8"	27-3/4"	10-7/8" + 1/8" gap	1" DEP.

DEP. = Dependently Rotating System

For custom applications, a trial installation is recommended.
Door edge profile, thickness and gaps all factor in installation.

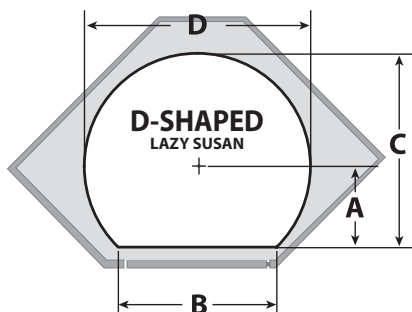
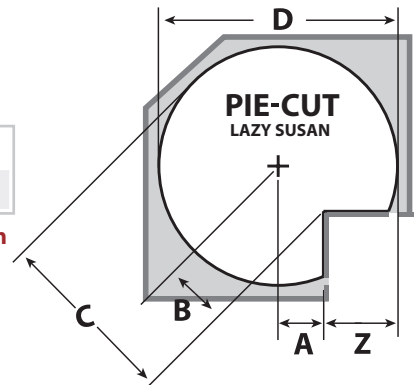

Shelf	Material	Series	A	B	C	D	Post System
20" D-Shaped	Maple	LD-4NW	8-3/8"	9-7/8"	18-1/8"	19-1/2"	1" IND.
28" D-Shaped	Maple	LD-4NW	11-7/8"	14-1/2"	25-3/4"	27-3/4"	1" IND.
32" D-Shaped	Maple	LD-4NW	13-1/2"	16-3/4"	29-3/8"	31-3/4"	1" IND.

IND. = Independently Rotating System

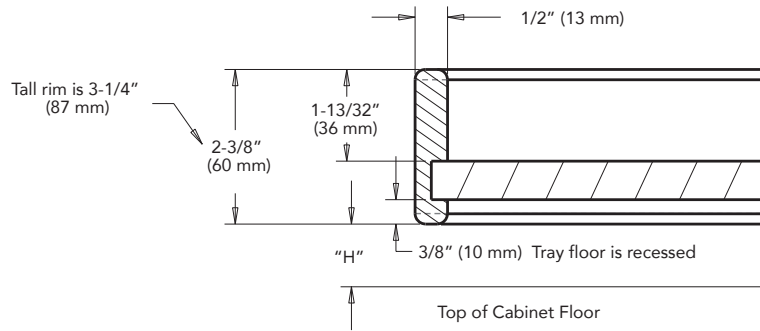

Hardware	Tray Shape	"H"
Aluminum	FC, Kidney and D-Shaped	31/32" (24 mm)
Telescoping Post	Full-Circle	7/8" (22 mm)
Telescoping Post	Kidney & D-Shaped	31/32" (24 mm)
Telescoping Post	Pie-Cut	1-3/4" (45 mm)

SPECIFICATIONS

HALF-MOON NATURAL WOOD SHELVES

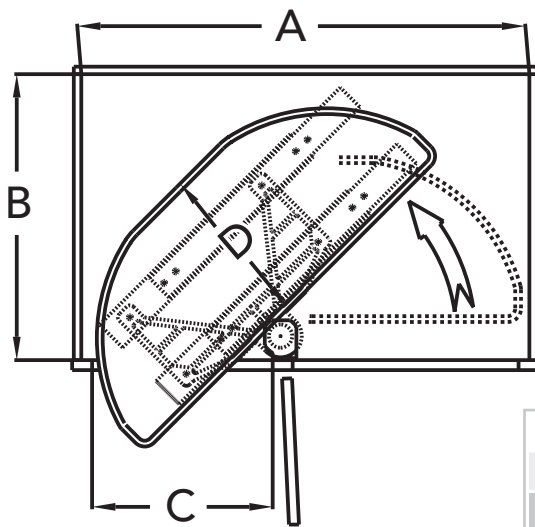

STANDARD AND 90-DEGREE
BRACKETS COME WITH EACH UNIT

FRAMED CABINET

DIMENSIONS A, B AND C ARE MINIMUMS. 32" TRAY SHOWN IN DIAGRAM.

NOM Tray size	A	B	C	D
32" (813 mm)	34-1/4" (870 mm)	22" (559 mm)	12" (305 mm)	11-1/8" (283 mm)
35" (889 mm)	37" (940 mm)	22" (559 mm)	15" (381 mm)	14-1/8" (359 mm)
38" (965 mm)	39-1/2" (1003 mm)	22" (559 mm)	18" (457 mm)	17-1/8" (435 mm)

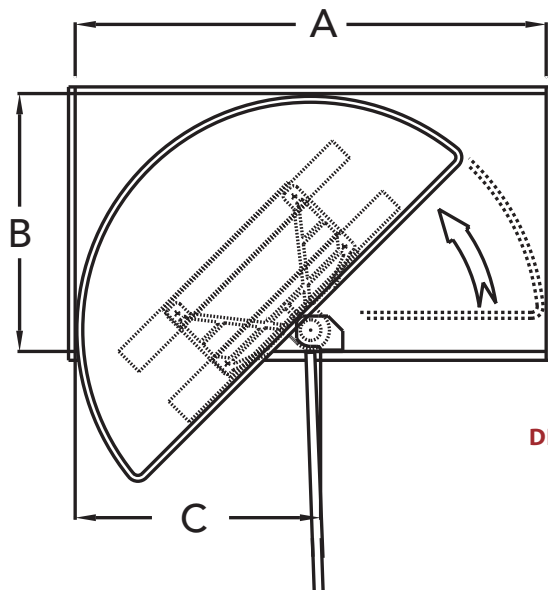

STANDARD AND 90-DEGREE
BRACKETS COME WITH EACH UNIT

FRAMELESS CABINET

DIMENSIONS A, B AND C ARE MINIMUMS. 38" TRAY SHOWN IN DIAGRAM.

NOM Tray size	A	B	C
32" (813 mm)	34-1/8" (867 mm)	22" (559 mm)	13-1/4" (387 mm)
35" (889 mm)	35-3/16" (897 mm)	22" (559 mm)	16-1/4" (413 mm)
38" (965 mm)	38-9/16" (980 mm)	22" (559 mm)	19-1/4" (489 mm)



- Designed for 36" kidney corner base cabinets
- Gray, maple or orion gray solid bottom shelves
- Single shelf set features aluminum swivel bearing with stop
- Double shelf set features independently rotating hardware and chrome-plated telescoping posts, which accommodates 26" to 32" inner cabinet heights
- TSCA Title VI compliant



53-401-32BSFOG-1
 (2) Shelf 36" Kidney-Shaped
 Lazy Susan
 (Orion gray finish shown)



53472-32MP-1
 (2) Shelf 36" Kidney-Shaped
 Lazy Susan
 (Maple finish shown)



53472-32GR-1
 (2) Shelf 36" Kidney-Shaped
 Lazy Susan
 (Gray finish shown)

Solid Bottom Kidney-Shaped Lazy Susans w/ 10" Aluminum Bearing for 36" Kidney Cabinets

PRODUCT	DESCRIPTION	DIMS	FINISH	SLP
53-401-32BSGR-1	Single Shelf	32" (813 mm) Diameter	Gray	\$271.15
53-401-32BSMP-1	Single Shelf	32" (813 mm) Diameter	Maple	\$271.15
53-401-32BSFOG-1	Single Shelf	32" (813 mm) Diameter	Orion Gray	\$301.60
(2) Shelf Solid Bottom Kidney-Shaped Lazy Susans for 36" Kidney Cabinets				
53472-32GR-1	(2) Shelf Set	32" (813 mm) Diameter	Gray	\$448.75
53472-32MP-1	(2) Shelf Set	32" (813 mm) Diameter	Maple	\$449.50
53472-32FOG-1	(2) Shelf Set	32" (813 mm) Diameter	Orion Gray	\$474.15

5881 Series

Chrome Wire Half-Moon Lazy Susan

- Pivots & pulls out
- Comes with cabinet mounting hardware
- Sleek wire construction that glides on a ball-bearing slide
- Easy installation



Chrome Wire Half Moon Lazy Susan

PRODUCT	DESCRIPTION	DIMS	MCO	CAB	FINISH	SLP
5881-33CR-1	Single Shelf Pivot and Slide	33-29/32" (861 mm) W x 18-1/2" (470 mm) L x 4-5/8" (188 mm) H	18-1/2" (469 mm)	BC48	Chrome	\$174.00

5LSF Series

Chrome Fence Railing



Full Circle Fence Rail

PRODUCT	DESCRIPTION	DIMS	FINISH	SLP
5LSF018-CR	Fence Railing	18" (457 mm) Diameter	Chrome	\$50.75
5LSF020-CR	Fence Railing	20" (508 mm) Diameter	Chrome	\$53.65
5LSF028-CR	Fence Railing	28" (711 mm) Diameter	Chrome	\$79.75
5LSF032-CR	Fence Railing	32" (813 mm) Diameter	Chrome	\$87.00

Full Circle Fence Rail

5LSF018-8CR	(8) Fence Railings	18" (457 mm) Diameter	Chrome	\$47.85 ea.
5LSF020-8CR	(8) Fence Railings	20" (508 mm) Diameter	Chrome	\$50.75 ea.
5LSF028-8CR	(8) Fence Railings	28" (711 mm) Diameter	Chrome	\$73.95 ea.
5LSF032-8CR	(8) Fence Railings	32" (813 mm) Diameter	Chrome	\$81.90 ea.

Kidney Shaped Fence Rail

5LSF424-CR	Fence Railing	24" (310 mm) Diameter	Chrome	\$82.65
5LSF428-CR	Fence Railing	28" (711 mm) Diameter	Chrome	\$94.25
5LSF432-CR	Fence Railing	32" (813 mm) Diameter	Chrome	\$98.60

Kidney Shaped Fence Rail

5LSF424-8CR	(8) Fence Railings	24" (310 mm) Diameter	Chrome	\$66.70 ea.
5LSF428-8CR	(8) Fence Railings	28" (711 mm) Diameter	Chrome	\$82.65 ea.
5LSF432-8CR	(8) Fence Railings	32" (813 mm) Diameter	Chrome	\$89.90 ea.

Not-So-Lazy Susan

Lazy Susan



- Designed for 33" and 36" kidney corner base cabinets
- Solid wood construction, maple
- Mounts to cabinet top and bottom
- Upper kidney-shaped shelf with mid-level arrester
- Lower kidney-shaped shelf
- Up to (7) hooks
- TSCA Title VI compliant

NSLS-KM-28S-7



(7) Adjustable hooks



Built-in positioner stop



NSLS-KM-28S-7
Not-So-Lazy Susan
(28" version shown)

NOTE: 154 lb. dynamic weight rating

Not-So-Lazy-Susan w/ Hardware and Hooks

PRODUCT	DESCRIPTION	DIMS	FINISH	SLP
NSLS-KM-28S-7	Single Shelf	28" (711 mm) Diameter	Wood	\$478.50
NSLS-KM-32S-7	Single Shelf	32" (813 mm) Diameter	Wood	\$521.25

Lazy Susan

Lazy Susan Light Kit

- 23" Angled Elli® LED linear light
- Door sensor
- 6W Plug-In power supply - Includes easy snap block
- Wire management clips



tresco
lighting



Round, Single Door Sensor
(Nickel)



6W Plug-In Power Supply



23" Angled Elli®



Wire Management
Adhesive Clips

Kit includes:

(1) Round, Single Door Sensor, (1) EquiLine Plug-In Power Supply, (1) Elli® LED Light fixture and (4) Wall Clips

Lazy Susan Lighting Kit

PRODUCT	DESCRIPTION	SLP
L-LED-LSKA1-1	Lighting Kit	\$200.70

Rev-A-Shelf® Hardware Kits for wood or melamine custom shelving are tested to meet and exceed BHMA Class-I specifications of 20 lbs. per square foot at 100,000 cycles. Our hardware and hardware components allow maximum flexibility, strength and aesthetic value for all custom applications.

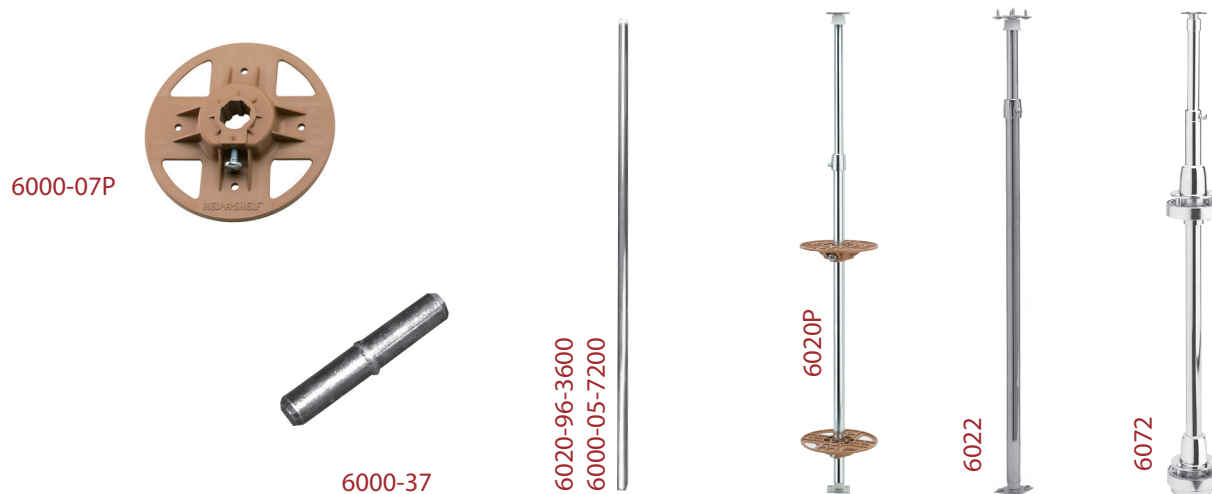

Shelf Support for Full Circle Shelves

PRODUCT	DESCRIPTION	DIMS	FINISH	SLP
6000-07P-52	Shelf Support	18" (457 mm) Diameter	Polymer	\$19.15

Center Post Adapter for Extending

6000-37-52	Post Adapter	20" (508 mm) Diameter	Metal	\$28.40
------------	--------------	-----------------------	-------	---------

3/4" Diameter Lower Post Assembly

6020-96-3100-2	31" Post (787 mm)	28" (711 mm) Diameter	Bright Zinc	\$23.50
6020-96-3600-2	36" Post (915 mm)	32" (813 mm) Diameter	Bright Zinc	\$29.85
6000-05-7200-2-52	72" Post (1829 mm)	18" (457 mm) Diameter	Bright Zinc	\$74.80

(2 Shelf) Full Circle Hardware Set for Custom Shelves

6020-04P-52	Hardware	20" (508 mm) Diameter	Polymer	\$58.75
-------------	----------	-----------------------	---------	---------

(2 Shelf) Full Circle Hardware Set for Custom Shelves

6020-04P-4	(6) Hardware Sets	3/4" Diameter Post (19 mm)	Polymer	\$49.45 ea.
6020-04P-426	(6) Hardware Sets	38"-46" (914 mm-1168 mm) H – 3/4" (19 mm) Diameter Post	Polymer	\$56.55 ea.

Full Circle Hardware Set for Rev-A-Shelf Polymer Shelves

6022-04-52	Hardware	3/4" Diameter Post (19 mm)	Bright Zinc	\$46.40
6022-04-52-526	Hardware	38"-46" (914 mm-1168 mm) H – 3/4" (19 mm) Diameter Post	Bright Zinc	\$49.30

Full Circle Hardware Set for Rev-A-Shelf Polymer Shelves

6022-04-4	(6) Hardware Sets	3/4" Diameter Post (19 mm)	Bright Zinc	\$37.40 ea.
6022-04-426	(4) Hardware Sets	38"-46" (914 mm-1168 mm) H – 3/4" (19 mm) Diameter Post	Bright Zinc	\$39.15ea.

Full Circle Hardware Set/Independently Rotating

6072-04-52	(2) Shelf Full Circle Hardware Set	1" Diameter Post (26 mm)	Chrome	\$117.45
6073-04-536	(3) Shelf Full Circle Hardware Set	38"-46" (914 mm-1168 mm) H – 1" (26 mm) Diameter Post	Chrome	\$181.25

NOTES: 6000-07P 5" (127 mm) DIAMETER SHELF SUPPORT FOR WOOD SHELVES (USE 6020/6022 SERIES HARDWARE KITS.)

6000-37 For joining two or more center posts together. (3/4" (19 mm) post diameter only) (6000 Series) 6020-96-3600 / 6000-05-7200 For use with full circle dependently rotating sets. 36" post for use in 36" & 42" (915-1067 mm) wall cabinet applications. 72" post for use with custom applications.

6020P For use with wood or laminate custom shelves.

6072 For use with independently rotating non-centering wood shelves.

CONTAINS: 6020 Top and bottom pivots 6000-90-2; post assembly 6020-97-2100-2; upper post assembly 6120-93-1200-2; collar assembly 6120-92-2; two full circle shelf supports 6000-07, and mounting screws.

6022 Top and bottom pivots 6000-90-2; 21" post assembly 6020-97-2100-2; 12" post assembly 6120-93-1200-2; collar assembly 6120-92-2; and mounting screws.

6072 (2) shelf hubs 6260-08-26; (2) shelf supports 6470-07-2; (1) collar 6260-92-26; (1) upper pivot 6000-91-2; (1) positioning base 6260-77-2; 22-1/2" (572 mm) lower post assembly 6470-96-2208-26; 9-1/4" (235 mm) upper post assembly (6470-93-0904-26) and mounting screws.

Hardware



4HDBM2-04-52



BM1-VL-4-SHUB-12



4B-10-8

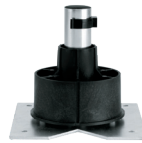

BM1-VL-4-LHUB-12



4BS-7-8



BM1-18-52

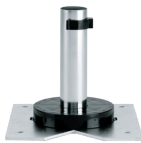

BM1-VL-04-52



BM1-04-52



4BM1-04-52



4BM1-18-52

Single Tray Hardware

PRODUCT	DESCRIPTION	DIMS	FINISH	SLP
BM1-VL-04-52	Value Line Single Tray Bottom Mount Post	4" (102 mm) Post	Zinc Coated	\$26.95
BM1-VL-4-SHUB-12	(12) Bottom Mount Hardware Sets w/ Wall Hub	4" (102 mm) Post	Zinc Coated	\$25.10 ea.
BM1-VL-4-LHUB-12	(12) Bottom Mount Hardware Sets w/ Base Hub	4" (102 mm) Post	Zinc Coated	\$24.65 ea.
BM1-04-52	Single Tray Bottom Mount Post	4" (102 mm) Post	Zinc Coated	\$33.15
4BM1-04-52	Wood Single Tray Bottom Mount Post	4" (102 mm) Post	Zinc Coated	\$39.15

Aluminum Lazy Susan Swivel Bearing w/ Stop

4BS-7-8	(8) 7" Bearings		Aluminum	\$50.75 ea.
4BS-10-8	(8) 10" Bearings		Aluminum	\$56.55 ea.

Aluminum Lazy Susan Bearing

4B-7-8	(8) 7" Bearings		Aluminum	\$42.05 ea.
4B-10-8	(8) 10" Bearings		Aluminum	\$47.85 ea.

(2) Shelf Lazy Susan Post Hardware

BM1-18-52	Two Tray Bottom Mount Post	18" (457 mm) Post	Zinc Coated	\$52.05
4BM1-18-52	Wood Two Tray Bottom Mount Post	18" (457 mm) Post	Zinc Coated	\$85.55
4HDBM2-04-52	Heavy Duty Two Tray Bottom Mount Post	18" (457 mm) Post	Almond Powder Coated	\$79.75



(2) Shelf Independently Rotating Centering Hardware

PRODUCT	DESCRIPTION	DIMS	FINISH	SLP
6272-04-52	Hardware	26"-32" (661-813 mm) I.C.H. 1" (26 mm) Diameter Post	Chrome	\$134.85

(5) Shelf Utility Cabinet Centering Hardware

6265-04-52	Hardware	56"-62" (1423-1575 mm) I.C.H. 1" (26 mm) Diameter Post	Chrome	\$279.00
------------	----------	--	--------	----------

1" Diameter Lower Post Assembly

6360-05-7008-26-52	Post Extension	70-1/2" (1791 mm) Post 1" (26 mm) Diameter	Chrome	\$88.45
6370-96-7008-26-52	1" Center Post Extension	70-1/2" (1791 mm) Post 1" (26 mm) Diameter	Chrome	\$92.80
6470-96-4008-26-52	1" Center Post Extension	1" (26 mm) x 40-1/2" (1029 mm) Post	Chrome	\$55.80
6260-38-1	Post Coupling for 1" Diameter	20" (508 mm) Diameter	Chrome	\$35.50

Pie Cut Hardware for Wood Shelves w/ Polymer Shelf Supports (24" or larger - custom trays)

6940-04-28P-52	Hardware Sets	3/4" (19 mm) Diameter Post	Bright Zinc/Chrome	\$94.25
----------------	---------------	----------------------------	--------------------	---------

Pie Cut Hardware for Wood Shelves w/ Polymer Shelf Supports (24" or larger)

6940-04-28P-4	(6) Hardware Sets	3/4" (19 mm) Diameter Posts	Bright Zinc	\$85.85 ea.
---------------	-------------------	-----------------------------	-------------	-------------

Center Post & Pivot Hardware for RAS Polymer Shelves (Individual Pack)

6942-04-28-52	Hardware		Bright Zinc	\$82.65
---------------	----------	--	-------------	---------

Shelf Supports for Pie Cut Hardware for Wood Shelves

6950-07P-52	Shelf Support	1" (26 mm) Diameter Post	Polymer	\$15.95
-------------	---------------	--------------------------	---------	---------

NOTES: 6272-04-52 For use with independently rotating centering shelves.

6265-04-52 For use with independently rotating centering shelves.

6360/6370 For use with independent rotating tray kits or hardware kits. Distributor post for use when needing longer post for pantry or kidney independently rotating hardware sets. Must be used with bushing supplied by factory or with extending collar 6260-38-26.

6940-04-28/P. Replaces part number 6120-04 for 24", 28", (610, 711 mm) or larger wood shelves only. Not for use with 18", 20" or 22" shelves. 1" (26 mm) dia. post.

6942-04-28-52 Replaces part number 6122-04-52 for 24" or 28" (610, 711 mm), shelves only. Not for use with 18", 20" or 22" shelves. (Contains large cam base) 1" (26 mm) dia. post.

CONTAINS: 6272-04-52 2 Shelf support assemblies, mounting hardware and telescoping center post assembly to accommodate 26"-32" (661-813 mm) I.C.H. 1" (26 mm) dia. post.

6265-04-52 Hardware for 5 shelf set with 56"-62" (1423-1575mm) I.C.H. post system. 1" (26 mm) dia. post.

6120-04-52 PC post assembly w/ shelf supports for 18-22" (457-559 mm) tray sets: also see 6940-04 kits.

6120-04-4 Top pivot 6140-03-2; cam base 6140-50-2; 21" (534 mm) post assembly 6120-97-2100-2; 12" (305 mm) post assembly 6120-93-1200-2; collar assembly 6120-92-2; shelf supports with adjustment screws 6140-07, and mounting screws.



LD-4BW-004



LD-4BW-004BM1



LD-4BW-004BM2



4SBS



LD-24BM2



LD-24BM1



LD-24

Lazy Daisy Banded Wood Hardware

PRODUCT	DESCRIPTION	DIMS	FINISH	SLP
LD-4BW-004-10	(10) Hardware for Banded Wood Full Circle w/ 26"-31" (660 - 787 mm) Telescoping Posts		Zinc/Almond	\$43.50 ea.
LD-4BW-00436-4	(4) Hardware for Banded Wood Full Circle 3 Tray Set w/ 38"-46" (965 - 1168 mm) Telescoping Posts		Zinc/Almond	\$73.95 ea.
LD-4BW-004-4	(4) Hardware for Banded Wood Full Circle w/ 26"-31" (660 - 787 mm) Telescoping Posts		Zinc/Almond	\$44.95 ea.
LD-4BW-004BM2-4	(4) Hardware for Banded Wood Full Circle Double Bottom Mounts		Zinc/Almond	\$26.80 ea.
LD-4BW-20436-4	(4) Hardware for Banded Wood D Shape 3 Tray w/ 38"-46" (965 - 1168 mm) Telescoping Posts		Zinc/Almond	\$62.35 ea.
LD-4BW-204-4	(4) Hardware for Banded Wood D Shape w/ 26"-31" (660 - 787 mm) Telescoping Posts		Zinc/Almond	\$44.95 ea.
LD-4BW-204BM1-8	(8) Hardware for Banded Wood D Shape Single Bottom Mounts		Zinc/Almond	\$35.50 ea.
LD-4BW-204BM2-4	(4) Hardware for Banded Wood D Shape Double Bottom Mounts		Zinc/Almond	\$29.25 ea.
LD-4BW-404-4	(4) Hardware for Banded Wood Kidney w/ 26"-31" (660 - 787 mm) Telescoping Posts		Zinc/Almond	\$43.50 ea.

Lazy Daisy Banded Wood Hardware

4SB-7-1	7" Lazy Susan Steel Swivel Bearing	Steel	\$17.40
4SB-7-10	(10) 7" Lazy Susan Steel Swivel Bearings	Steel	\$12.30 ea.
4SB-10-1	10" Lazy Susan Steel Swivel Bearing	Steel	\$23.95
4SB-10-10	(10) 10" Lazy Susan Steel Swivel Bearings	Steel	\$15.25 ea.
4SBS-7-1	7" Lazy Susan Steel Swivel Bearing With Stop	Steel	\$19.55
4SBS-7-10	(10) 7" Lazy Susan Steel Swivel Bearings w/ Stop	Steel	\$14.50 ea.
4SBS-10-1	10" Lazy Susan Steel Swivel Bearing w/ Stop	Steel	\$26.10
4SBS-10-10	(10) 10" Lazy Susan Steel Swivel Bearings w/ Stop	Steel	\$20.30 ea.

Lazy Daisy Polymer Hardware

LD-20-0431-5	(5) Hardware for Polymer Full Circle, Kidney, D-Shape w/ 30-35" (762 - 889 mm) Telescoping Posts	Zinc/White	\$36.25 ea.
LD-24-0436-5	(5) Hardware for Polymer Kidney 3 Tray w/ 34-41" (863 - 1041 mm) Telescoping Posts	Zinc/White	\$43.50 ea.
LD-24-04-5	(5) Hardware for Polymer Kidney w/ 26-31" (660 - 787 mm) Telescoping Posts	Zinc/White	\$25.40 ea.
LD-24BM1-04-10	(10) Hardware for Polymer Kidney Single Bottom Mounts	Zinc/White	\$17.40 ea.
LD-24BM2-04-5	(5) Hardware for Polymer Kidney Double Bottom Mounts	Zinc/White	\$21.75 ea.

6882-1008-04-52
Half Moon Extension Slide Kit



6841 Rev-A-Tray Half Moon
Hardware Kit

6842-04 Half Moon
(2) Shelf Hardware Kit

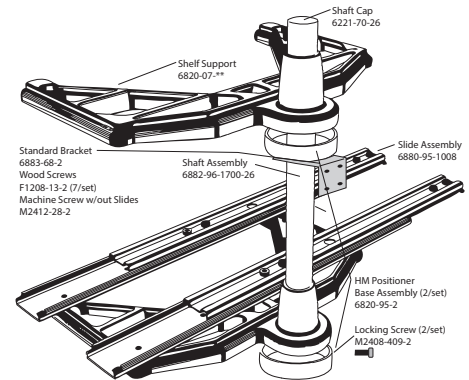

Half Moon Hardware Kit (Individual Pack)

PRODUCT	DESCRIPTION	DIMS	FINISH	SLP
6841-04-52	Single Rev-A-Tray Hardware Kit		Metal	\$94.40
6842-04-570	(2) Shelf Hardware Kit without Slides		Metal	\$201.55
6882-1008-04-52	Extension Slide Kit	10-1/2" (267 mm) Extension	Metal	\$65.25
6882-04-52	(2) Shelf Hardware Kit with Slides		Metal	\$292.90

CONTAINS:

6842-04-570 Two (2) shelf supports 6820-07-**; (2) positioning bases (6820-95-2); 1 standard bracket (6883-68-2); 15-7/8" (404 mm)

680 post (6882-96-1514-26)—Also includes template and installation instructions.

6882-1008-04-52 Slide kit only. (1) pair with screws. Individually packaged.

JPE SERIES POLYMER COMPONENT PARTS BULK

Rev-A-Shelf® custom molds many component parts for the cabinet industry, furniture industry and many other industries. We utilize high-quality, engineering-grade polymer materials such as ABS for our shelf clips. Should you require any custom polymer component parts, please contact customer service.

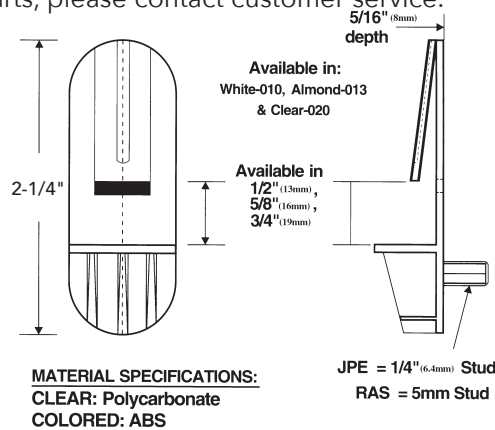
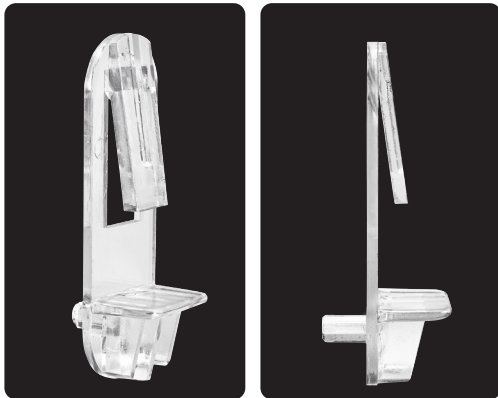

1/4" Boss Polymer Locking Shelf Clips (Bulk Pack)

PRODUCT	DESCRIPTION	DIMS	FINISH	SLP
JPE 301-12-020-1	Shelf Locking Clip	1/2" (13 mm)	Clear	\$.20 ea.
JPE 301-34-0**-1	Shelf Locking Clip	3/4" (19 mm)	White or Clear	\$.20 ea.
JPE 301-58-0**-1	Shelf Locking Clip	5/8" (16 mm)	White or Clear	\$.20 ea.
RAS SERIES—5MM Boss Polymer Locking Shelf Clips (Bulk Pack)				
RAS 305-12-0**-1	Shelf Locking Clip	1/2" (13 mm)	White or Clear	\$.20 ea.
RAS 305-34-0**-1	Shelf Locking Clip	3/4" (19 mm)	White or Clear	\$.20 ea.
RAS 305-58-0**-1	Shelf Locking Clip	5/8" (16 mm)	White or Clear	\$.20 ea.

NOTES:

JPE 301/RAS 305 **Denotes: White - 010 or Clear - 020 clear polycarbonate

SPECIFICATIONS

HARDWARE PART IDENTIFICATION

6940 SERIES PIE CUT

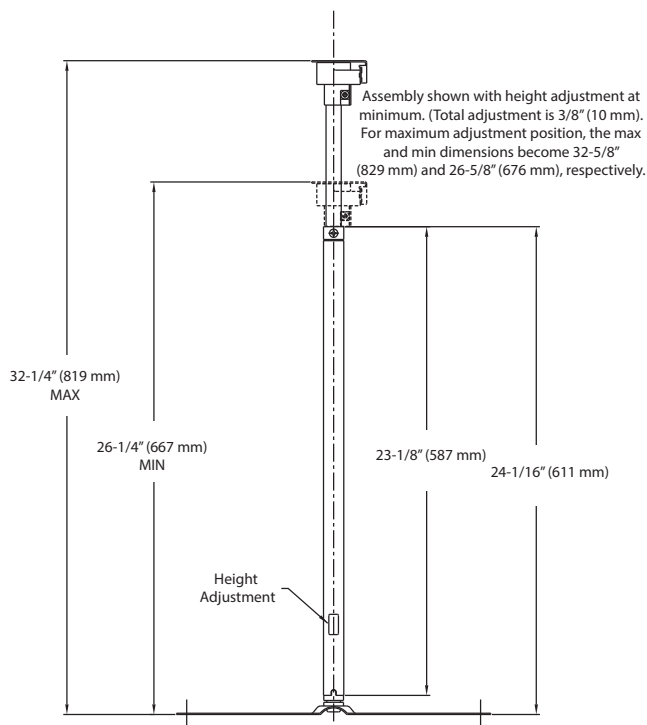

FULL CIRCLE - Dependent Rotating

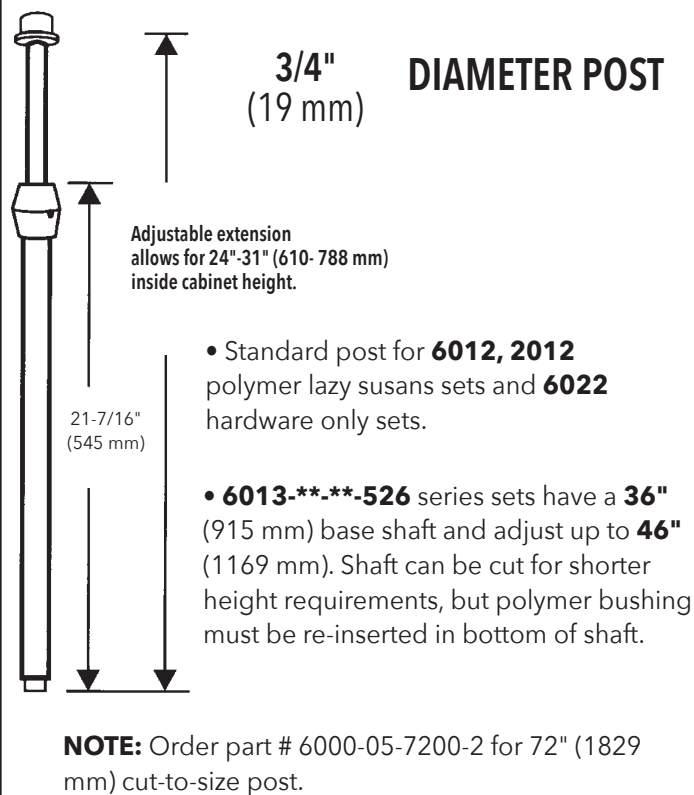

FULL CIRCLE/KIDNEY Independently Rotating

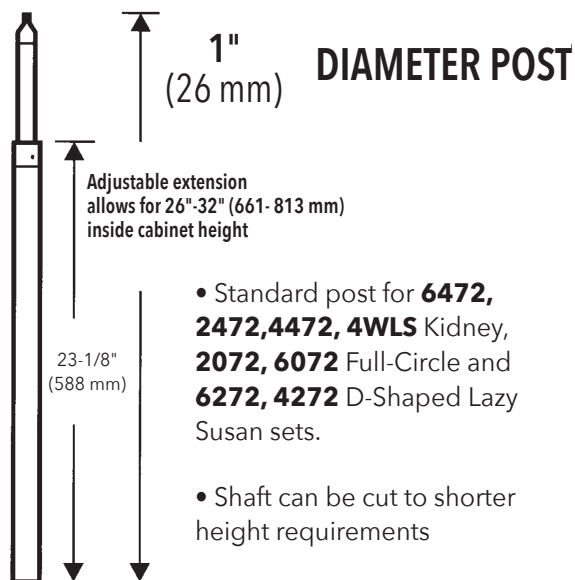

NOTE: Order part # 6370-96-7008-26 for 70-1/2" (1791 mm) cut-to-size post w/ bushings.

Hardware for Lazy Daisy Polymer

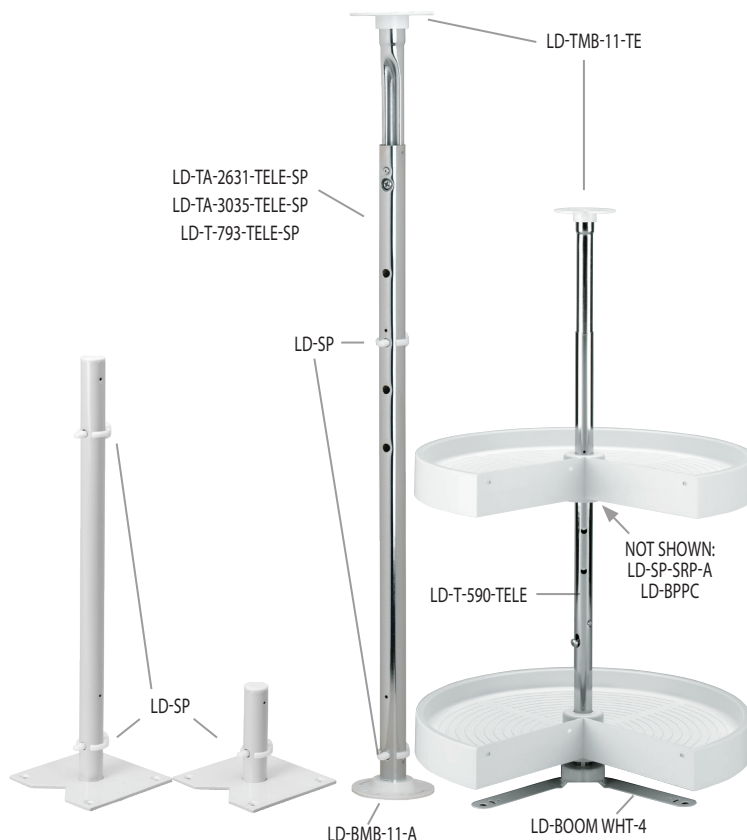

SPECIFICATIONS

HARDWARE KIT PARTS LIST

Hardware for Value Line Trays

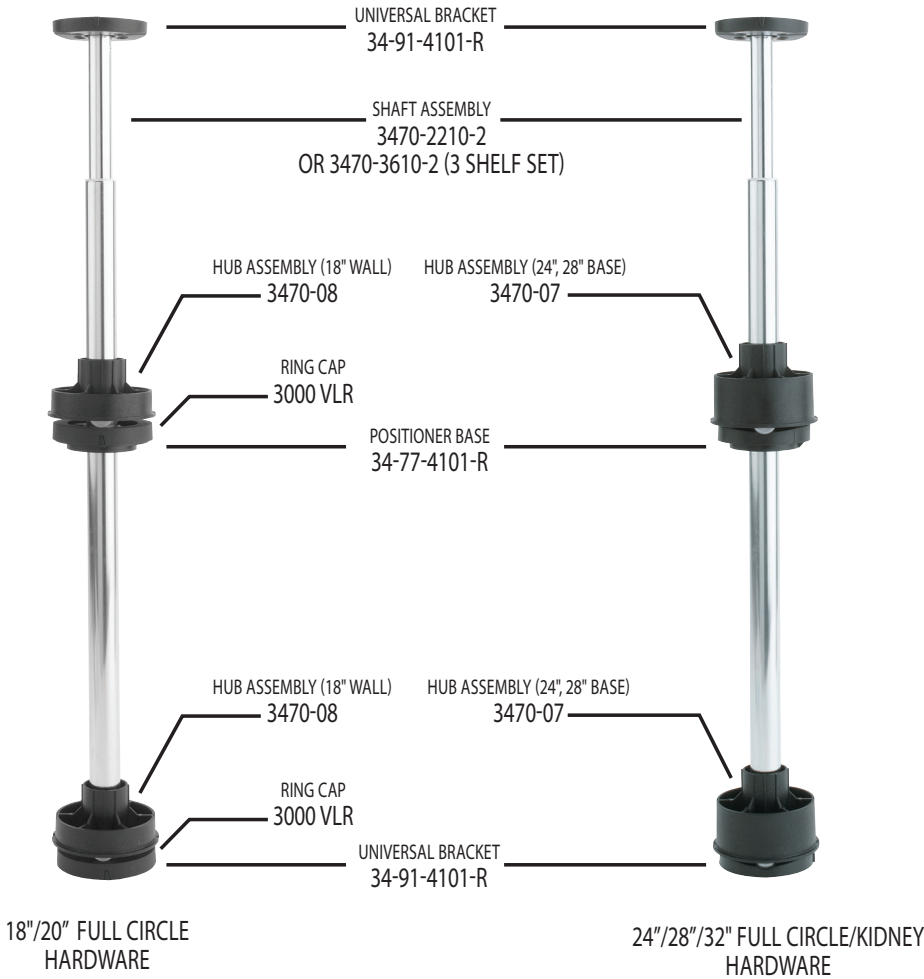

Hardware for LD Banded Wood

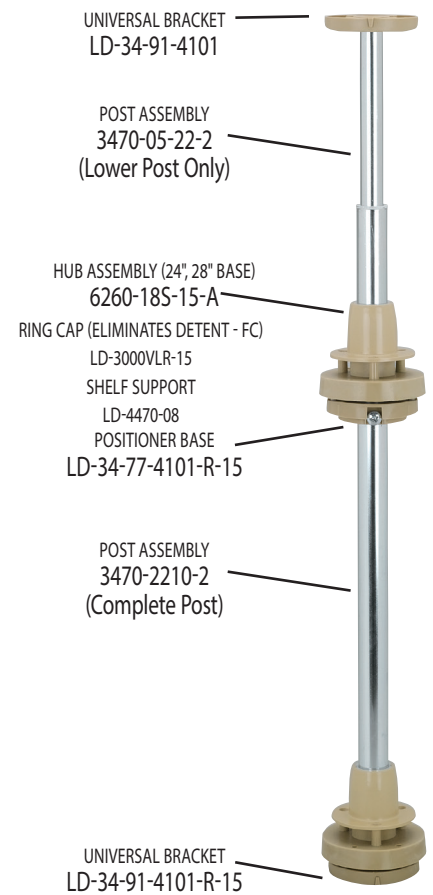

Hardware for RAS Polymer Trays

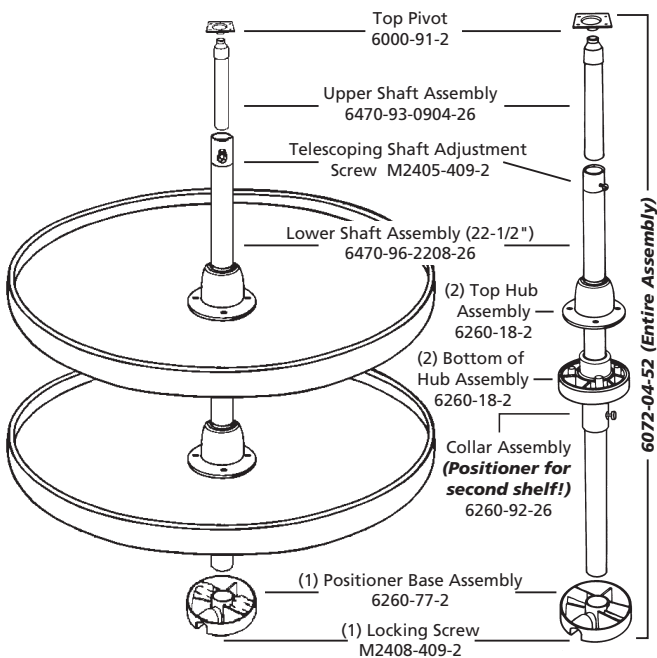

Hardware for 4WLS/LD-NATURAL

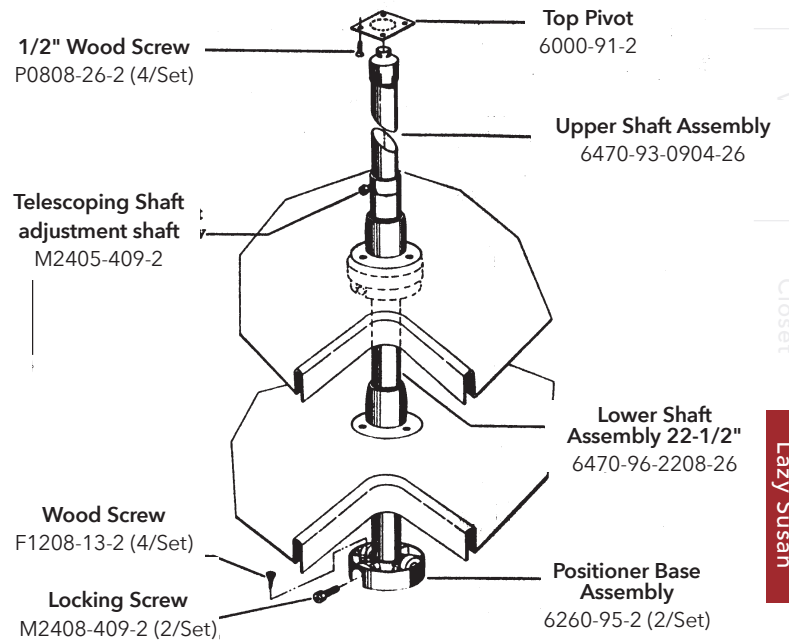

SPECIFICATIONS

HARDWARE KIT PARTS LIST

DEPENDENTLY ROTATING

INDEPENDENTLY ROTATING

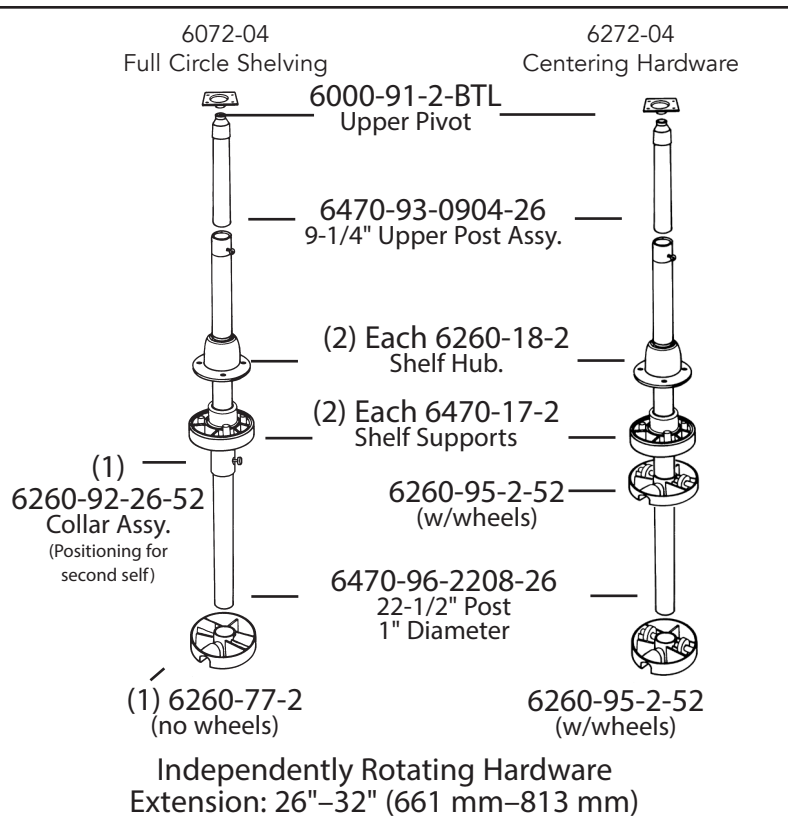
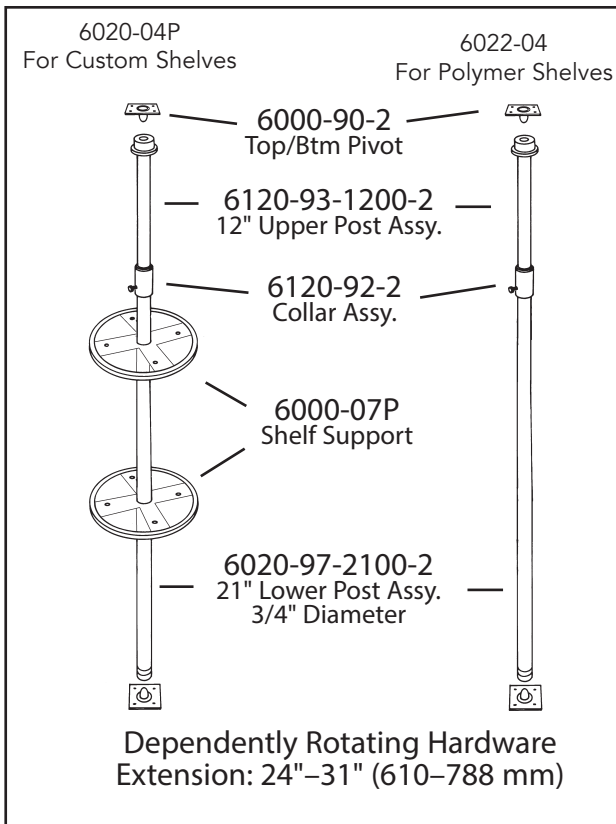

UTILITY CABINET CENTERING 6265-04

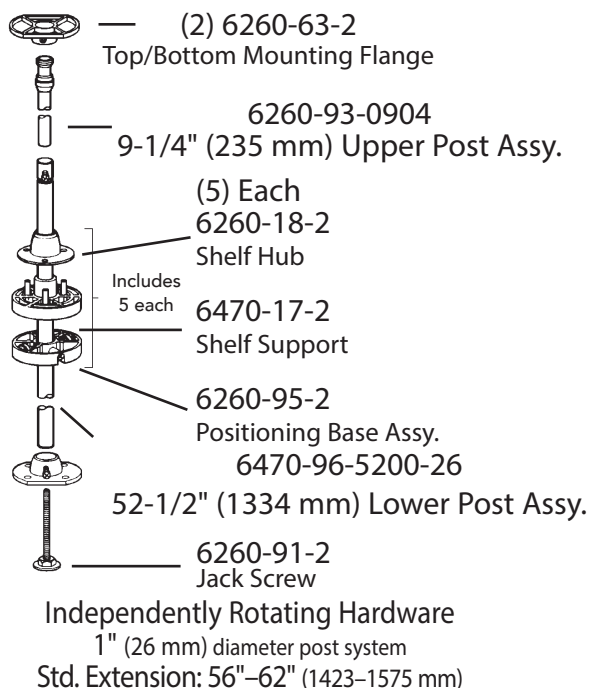

PIE CUT

6940-04 6942-04
For Custom Shelves
For Polymer Shelves

